

# 42" SLAB Console

**Model Shown: 9111-S-H38-D4S-D4D-D11D**

42" Long SLAB Console, Satin Finish Frame, Blanco Solid Surface Drawers, Configured for a 3-Hole 8" Centerset Faucet Supplied by Customer

- **42" LONG CAST WHITE SOLID SURFACE DECK WITH INTEGRAL BASIN IN STAINLESS STEEL CONSOLE FRAME**
- **BASIN IS INTEGRAL TO WHITE SOLID SURFACE DECK - ENTIRELY CAST IN ONE PIECE OF WHITE-COLORED POLYMER RESIN**
- **STAINLESS STEEL FRAME CONSTRUCTION IN SATIN MIRA (HIGH POLISH)**
- **INTEGRATED OVERFLOW WASTE OUTLET**
- **ADJUSTABLE LEVELERS FOR UNEVEN FLOORS**
- **MATERIAL OF CONSTRUCTIONS PHYSICAL PROPRIETIES IN COMPLIANCE WITH:**  
**CSA B45.5/IAPMO Z124**  
**ANSI/APA SS-1**

(REFER TO TECHNICAL DATA SHEET FOR COMPLETE DETAILS)

- **GREENGUARD CERTIFIED FOR LOW EMISSIONS**



Recyclable  
Product



ADA COMPLIANT

	DESCRIPTION	MODEL/OPTION #
<b>Add (+)</b>	<b>A ORIENTATION</b> - Required Selection	INIT.
	<input type="checkbox"/> <b>Console with Integral Basin</b>	9111
	42" L x 22" W x 34" H (1067 x 559 x 864 mm) with 14" L x 17" W x 4" H (356 x 432 x 102 mm) Basin	
<b>Add (+)</b>	<b>B FRAME</b> - Required Selection	INIT.
	<input type="checkbox"/> <b>Satin Finish</b> (Standard)	-S
	<input type="checkbox"/> <b>Mira Finish</b> (High Polish)	-HP
<b>Add (+)</b>	<b>C COUNTER COLOR SELECTION</b> - Req'd Selection	INIT.
	<b>Corterra® Solid Surface Color</b>	
	Color: _____	
	(Refer to <a href="https://www.neo-metro.com/luxury-solid-surface">https://www.neo-metro.com/luxury-solid-surface</a> for available colors)	

<b>Add (+)</b>	<b>D BASIN SELECTION</b> - Required Selection	INIT.
	<input type="checkbox"/> <b>Square Basin</b>	-BBSQ
	14" L x 14" W x 4" H Basin (356 x 356 x 102 mm)	
	<input type="checkbox"/> <b>Oval Basin</b>	-BBOV
	14" L x 17" W Basin (356 x 432 mm)	
	<input type="checkbox"/> <b>Round Basin</b>	-BBRD
	Ø16" Basin (Ø 406 mm)	
	<input type="checkbox"/> <b>Ramp Basin</b>	-BBRA
	14" L x 17" W Basin (356 x 432 mm)	
	<input type="checkbox"/> <b>Rectangular Basin</b>	-3676
	33" x 14" Basin (-DBL Not Available) (838 x 356 x 102 mm)	
	Overflow Waste is Built-in	
	Specify Plate Finish:	
	<input type="checkbox"/> Satin (Standard)	<input type="checkbox"/> High Polish

**REQUIRED**

Please indicate location of basin:	<b>BACK OF DECK</b>	<b>BACK OF DECK</b>	<b>BACK OF DECK</b>
	<input type="checkbox"/> -LH Left Offset	<input type="checkbox"/> -CTR Centered	<input type="checkbox"/> -RH Right Offset

<b>Add (+)</b>	<b>E OPTIONS</b>	INIT.
	<input type="checkbox"/> <b>Optional Storage Shelf</b>	-SWB
	Blanco Solid Surface	
	<input type="checkbox"/> <b>Optional Stainless Steel Towel Bar</b>	-TBS
	Satin Finish	
	Mira (high polish)	-TBS-HP

<b>Add (+)</b>	<b>F FAUCET CONFIG.</b> - Optional Selection	INIT.
	<input type="checkbox"/> <b>No Faucet Hole</b>	-H0
	For wall mounted faucet	
	<input type="checkbox"/> <b>Single Hole</b>	-H1
	Ø1-5/16" Centered Hole	
	<input type="checkbox"/> <b>6" Centerset</b>	-H36
	(152 mm)	
	<input type="checkbox"/> <b>8" Centerset</b>	-H38
	(203 mm)	

Customer is required to submit Faucet Spec Sheet to confirm compatibility with Neo-Metro's faucet drilling.

<b>Add (+)</b>	<b>G DRAWER CONFIG.</b> - Optional Selection	INIT.
	<input type="checkbox"/> <b>4" Short Depth Drawer</b>	-D4S
	Left Side Right Side	
	<input type="checkbox"/> <b>4" Std. Depth Drawer</b>	-D4D
	Left Side Right Side	
	<input type="checkbox"/> <b>11-1/2" Std. Depth Drawer</b>	-D11D
	Left Side Right Side	

## 42" SLAB Console

**PRODUCT Specification . . .** The 42" Slab Console /Table includes a 2-1/2" (64mm) thick solid surface Deck with an integral 14" x 17" x 4" depth (356 x 432 x 102mm) solid surface Basin. Solid Surface Basin comes with 1-1/4" Drain hole is provided to accommodate any Drain assembly with Overflow (Drain and P-Trap not included). The Frame is constructed out of Satin Finish (standard) stainless steel rectangular Tubing. The stainless steel Frame is also

available in Mira Finish The Solid Surface Countertop is available in a variety of standard colors. An optional Storage Shelf and Drawers are available. Adjustable Levelers are provided on each Leg for uneven floors. Installation instructions are provided.

Neo-Metro assumes no responsibility for use of void or suspended data. All dimensions are nominal and subject to manufacturer change without notice.

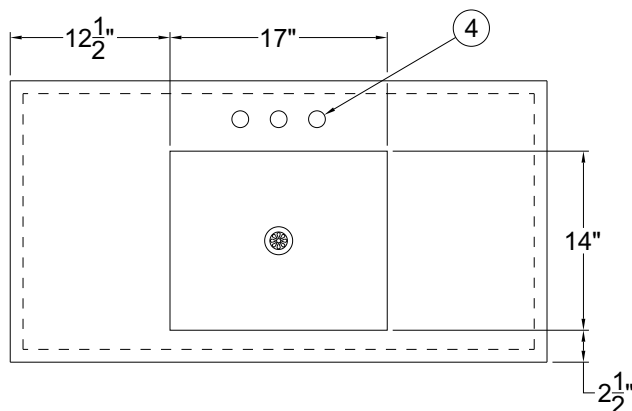

- ① STAINLESS STEEL SQUARE TUBING FOR LEGS AND FRAME
- ② ADJUSTABLE LEVELERS (ALL 4 LEGS)
- ③ 17" X 14" INTEGRAL BASIN
- ④ OPTIONAL -H36 THREE HOLES WITH 6" CENTERS FOR VALVE BY OTHERS
- ⑤ OPTIONAL -D4S 4" SHORT DEPTH
- ⑥ OPTIONAL -D4D 4" STANDARD DEPTH
- ⑦ OPTIONAL -D11D 11-1/2" STANDARD DEPTH

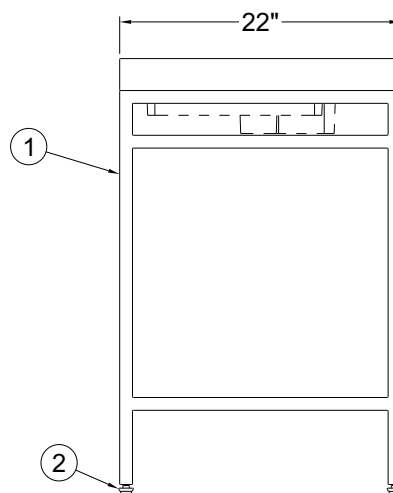
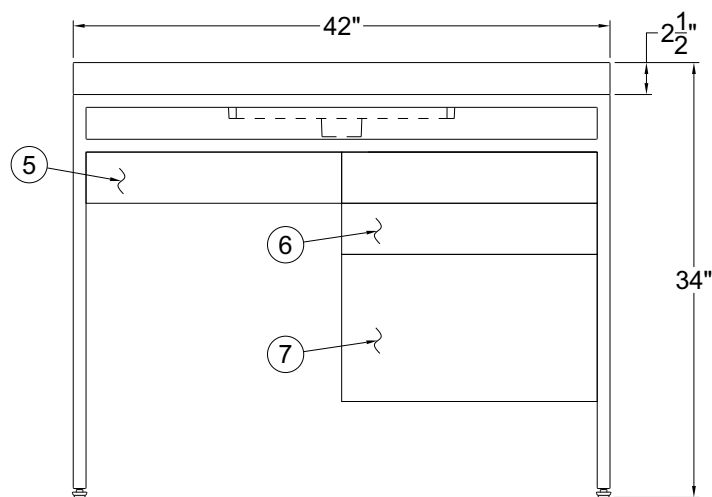

### APPROVAL FOR MANUFACTURE

COMPANY: \_\_\_\_\_

PROJECT NAME: \_\_\_\_\_

SIGNEE'S NAME WRITTEN CLEARLY: \_\_\_\_\_

DATE: \_\_\_\_\_

AUTHORIZED SIGNATURE: \_\_\_\_\_

**⚠ WARNING:** Cancer and Reproductive Harm - [www.P65Warnings.ca.gov](http://www.P65Warnings.ca.gov)

**NEO-METRO® by ACORN®**

A Member of Morris Group International

15125 Proctor Avenue • City of Industry, CA 91746 USA  
TF 800.488.8999 • PH 626.366.4561 • FX 626.961.2200