



TIRED OF
WAITING?



**CHRONOMITE®
BOOSTER HEATERS**

INSTANT-FLOW® Micro Tankless
Water Heater (M SERIES)

MIGHTY-mite® Tankless Water
Heater (R SERIES)

ENJOY YOUR
HOT WATER
**FOR AS LONG
AS YOU WANT.**

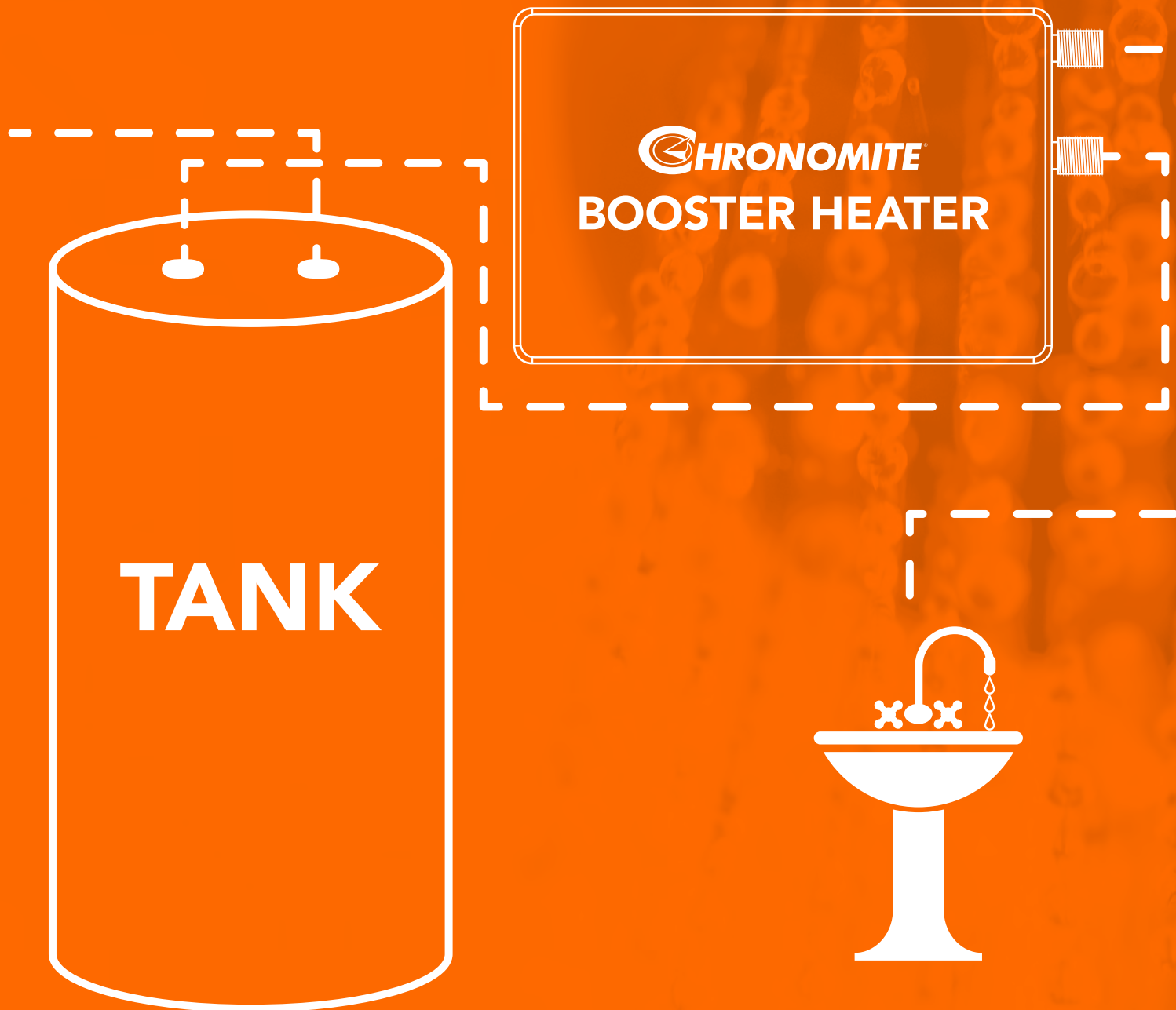

An insufficient hot water heater can turn a daily shower into a game of Russian Roulette. One minute, you're rinsing the sleep from your eyes and reaching for the shampoo bottle. Then, in the blink of eye, the water temperature plummets.

What about trading your current hot water heaters for bigger models? Larger tanks might solve capacity problems, but they are an expensive remedy. Also, homeowners ought to consider not only the upfront costs but the recurring energy expenses. Extra gallons of hot water require extra natural gas or electricity. Homeowners will end up spending more on their utilities than ever—and because of standby heat losses typical of tanked hot water systems, they'll waste more energy in the process.

CHRONOMITE BOOSTER HEATERS TO THE RESCUE! How can this simple addition to a standard hot water tank help your system deliver more hot water and conserve energy at the same time?

Installing a Chronomite Booster Water Heater to your conventional hot water tank immediately increases its capacity 50%(M Series) or 100%(R Series).

Chronomite Booster Water Heaters vigilantly monitor the temperature of water passing from your hot water tank into the pipes that distribute water throughout your home. Once the temperature drops, the Chronomite Booster Water Heater kicks in for the power you need, right when you need it. Once the tank begins sufficiently pumping out hot water again, Chronomite Booster Water Heater shuts itself off. Automatically. **IT'S THAT SIMPLE.**

Everyone loves a hot shower, and Chronomite Booster Water Heater won't disappoint. This smart investment into added capacity and automatic operation rewards buyers with future energy savings across the board. **THAT'S MONEY WELL SPENT.**



BOOSTER HEATER INSTALLATION

- ① Chronomite Booster Heater
- ② Electrical Junction Supply Box (optional)
 - ②A 2095-1 Disconnect Switch (option M-40/240 only)
 - ②B 2094-4 Disconnect Switch (option R-58S/240 only)
- ③ Electrical Supply Conduit
- ④ Electrical Supply Wire
- ⑤ Ball Valve
- ⑥ Union

- Turn off the circuit breaker to avoid dangerous electrical shocks.
- Turn off the water supply.
- Do not apply heat to inlet or outlet fittings on heater. Do not solder direct.
- Flush supply line of all foreign material such as pipe dope, pipe chips, solder, sand, etc. before making up supply connections after working on water piping.

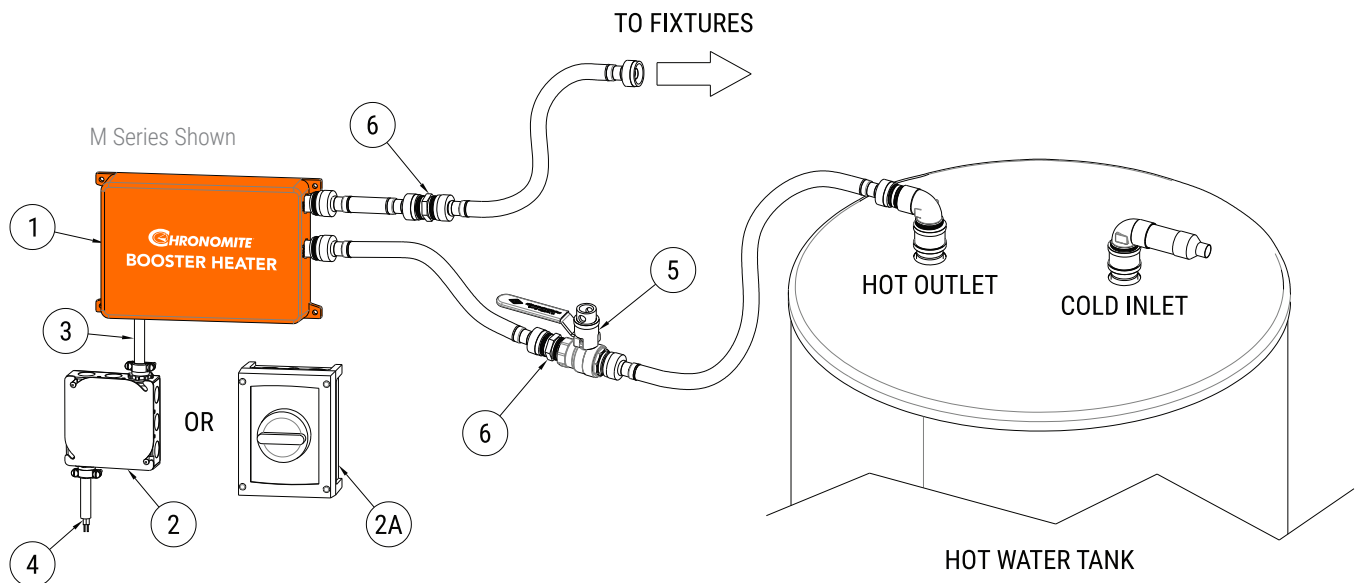

INSTALLATION LAYOUT—BOOSTER HEATER WITH TANK

Remove cover off of water heater. Attach conduit to the conduit connection punching. Then feed wires. Do not attach wiring.

Mount unit horizontally against the wall so the silver label reads correctly (See Above). Use level to ensure unit is level and mount with four screws through the flanges located on each corner using molly anchors or fasteners.

Connect plumbing. Use female 3/4" NPT or hose at cold water inlet and hot water outlet to 3/4" fittings (See Figure 1A).

DO NOT APPLY HEAT TO THESE FITTINGS WHILE CONNECTED TO HEATER.

Run water through the unit to expel all air bubbles. Cycle hot side of faucet 10 times to assist in removing air bubbles. Check for leaks at all fitting joints. If no leaks proceed to electrical installation.

CAUTION: HEATING ELEMENTS MAY BURN OUT IF UNIT IS NOT MOUNTED HORIZONTALLY

NOTE: FAILURE TO COMPLY WITH CODE REQUIREMENTS VOIDS THE WARRANTY.

INSTANT-FLOW® MICRO MODEL M SERIES

INSTANT-FLOW® M SERIES

STANDARD FLOW

MODEL	ACTIVATION GPM	VOLTS	KW	AMPS/Ø	90°C WIRE	°F TEMPERATURE RISE @			
						0.65 GPM	1.0 GPM	1.5 GPM	2.0 GPM
M-40/240 ADJ-NP	0.65	240	9.60	40	8 AWG	90+	66	44	33

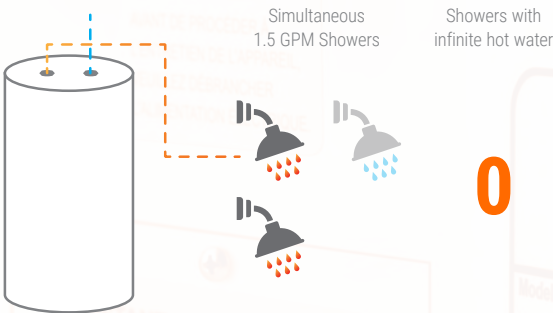

WITHOUT the INSTANT-FLOW® MICRO
40 GALLON CAPACITY

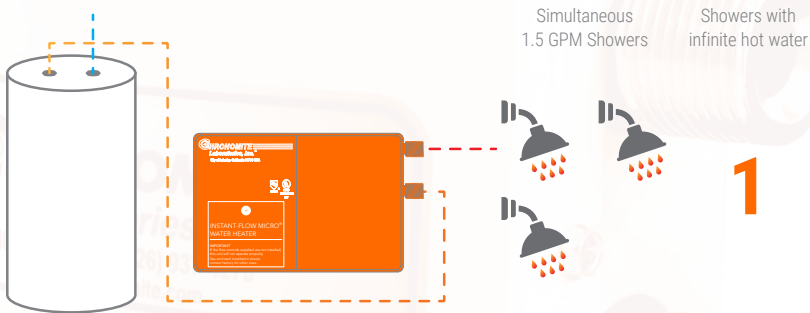

WITH the INSTANT-FLOW® MICRO
HOT WATER CAPACITY INCREASED TO 60 GALLONS!

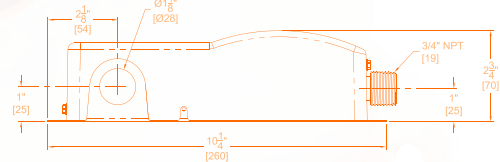
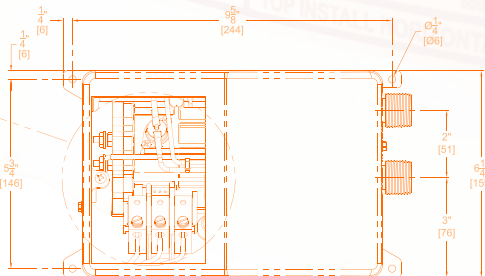
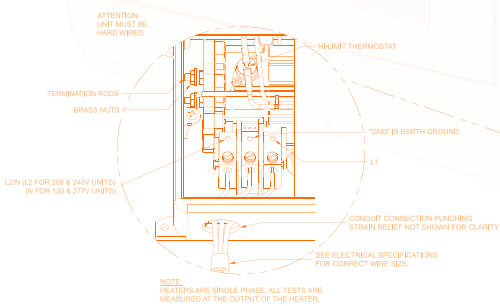

More hot water for more, or longer, showers.



Achieves its boosting effect at 99% efficiency.



Makes smaller tanks perform like larger tanks.

MIGHTY-MITE® MODEL R SERIES

MIGHTY-MITE® R SERIES

STANDARD ACTIVATION FLOW RANGE .65 - 5.0 GPM

°F TEMPERATURE RISE @

MODEL	ACTIVATION GPM	VOLTS	KW	AMPS/Ø	75°C WIRE	0.65 GPM	1.0 GPM	1.5 GPM	2.0 GPM	3.0 GPM	4.0 GPM
R-58S/240	0.65	240	13.90	58	6 AWG	90 +	90 +	63	47	32	24

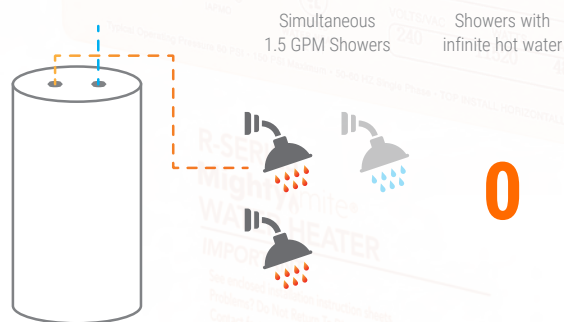

WITHOUT the **MIGHTY-mite®**

40 GALLON CAPACITY

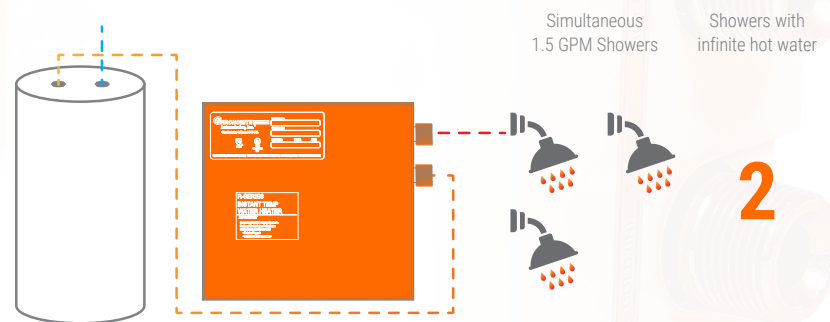

WITH the **MIGHTY-mite®**

HOT WATER CAPACITY INCREASED TO **80 GALLONS!**

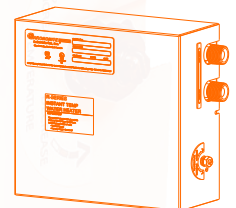
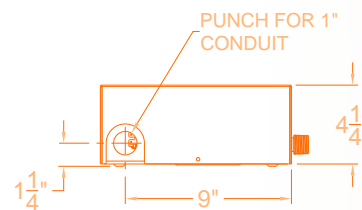
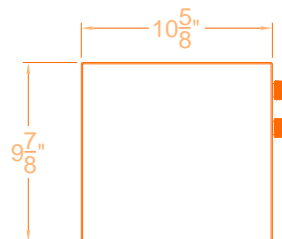
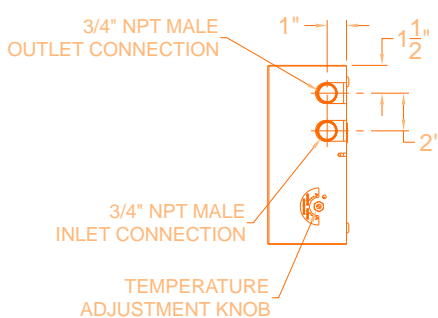

Fast and accurate hot water for convenience and comfort.



Saves space.
Saves Energy.



Saves money by preventing the increased standby losses of a larger tank replacement.

INSTALLATION LAYOUT

Chronomite Booster Heaters work with your existing tank-style water heater to deliver the power and the hot water you need, right when you need it. A single Booster Heater has enough power to provide hot water to multiple points of use, ideal for whole house applications.

View the installation layout below to see how a single R Series Booster Heater can assist in providing hot water to the upstairs shower and bathroom sink, as well as the downstairs kitchen sink and dishwasher. Booster Heaters save energy, conserve water and deliver hot water to the source in the snap of a finger!

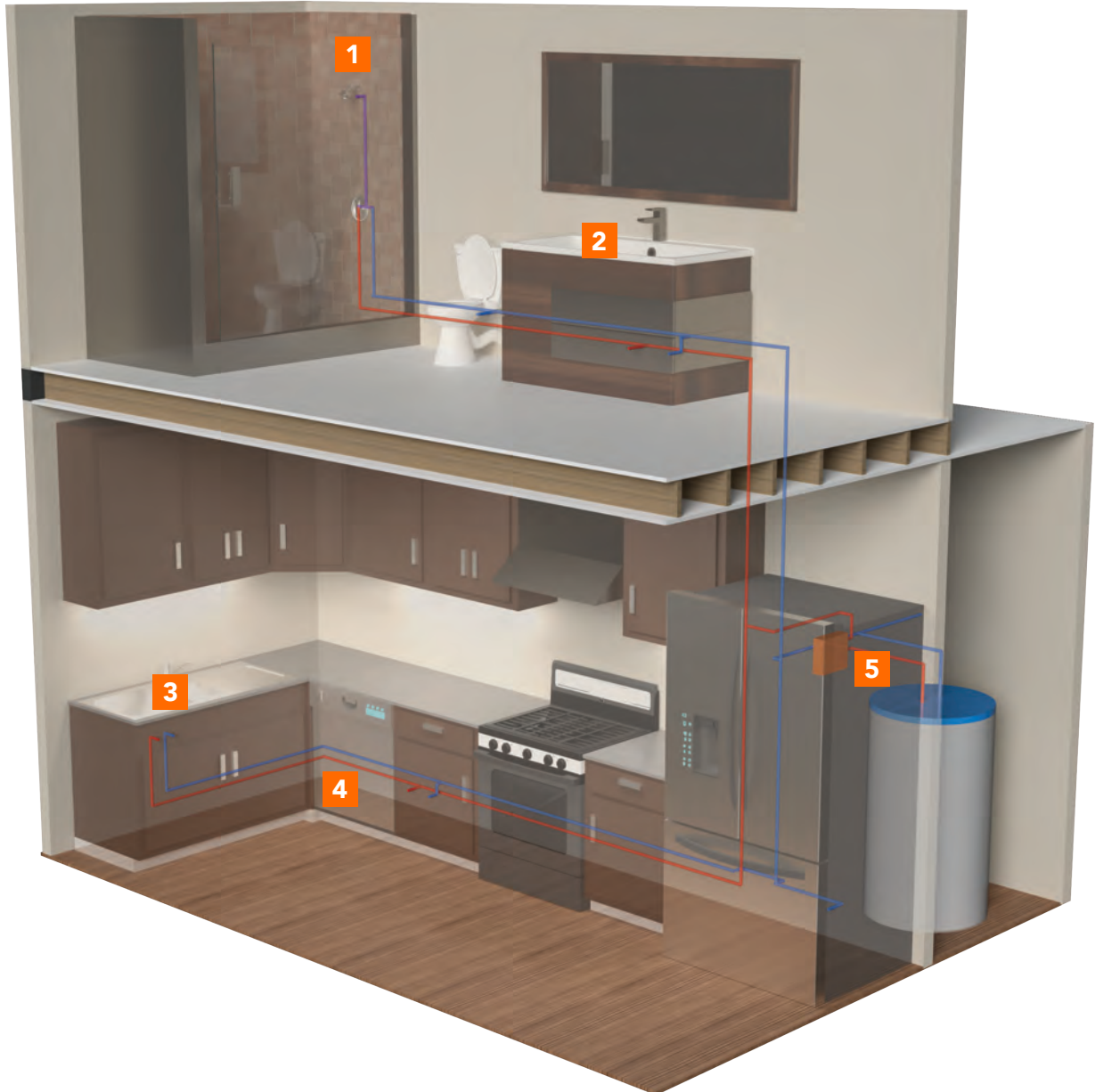

1 Shower with mixing valve

3 Kitchen Sink

5 Chronomite Booster Heater (R Series shown)

2 Bathroom Sink

4 Dishwasher



 **WARNING:** Cancer and Reproductive Harm - www.P65Warnings.ca.gov

 **CHRONOMITE**
Electric Tankless Water Heaters

Since 1966

17451 Hurley St. • City of Industry, CA 91744 • U.S.A.
Tel 800-447-4962 • 626-937-4270 • www.chronomite.com

INNOVATIVE SPIRIT AND ENGINEERING FOUNDATION

"What sets us apart from competitors is our engineering and spirit. We have a 'can-do' spirit. If you ask us to do something, we will do it or figure out how to do it. That's the part our customers like, that's the part we like." - Don Morris, President and CEO



MORRIS GROUP
INTERNATIONAL™

BRANDS BUILT TO LAST

L1001438
04/19