

SLAB Shower Base



Model Shown: CSB6030-TDS-L-NCD2
60" x 30" Shower Base with Left Hand Trench Drain



Model Shown: CSB3636ADA-RDD-NCD2-C
36" x 36" Shower ADA Base with Centered Round Drain and Waste Assembly

● GREENGUARD GOLD CERTIFIED FOR LOW EMISSIONS

● ADA COMPLIANT BASES AVAILABLE

● MEETS ASTM F 462-79 (R-2007) FOR SLIP RESISTANCE

● PHYSICAL PROPERTIES COMPLIES WITH:
CSA B45.5/IAPMO Z124
ANSI/ICPA SS-1

(REFER TO TECHNICAL DATA SHEET FOR COMPLETE DETAILS)



APPROVAL FOR MANUFACTURE

COMPANY: _____

PROJECT NAME: _____

SIGNEE'S NAME PRINTED CLEARLY: _____

DATE: _____

AUTHORIZED SIGNATURE: _____

MODEL/OPTION

- A** TYPE and SIZE - Required Selection INIT. _____
- ☐ CSB3636 Solid Surface Shower Floor 36"x36"
 - ☐ CSB3636ADA Solid Surface ADA Shower Floor 36"x36"
 - ☐ CSB6030 Solid Surface Shower Floor 60"x30"
 - ☐ CSB6030ADA Solid Surface ADA Shower Floor 60"x30"

- Add(+)** **B** DRAIN OPTIONS - Must Specify INIT. _____
- ☐ -RDD Round Drain Opening
 - ☐ -TD Trench Drain (Must Specify Below If Selected)
 - ☐ -TDS Trench Drain Cover Satin Finish
 - ☐ -TDW Trench Drain Cover White Powder Coated
 - ☐ -TDP Trench Drain Cover High Polished
 - ☐ -TDC Trench Drain Custom Design (Contact factory)

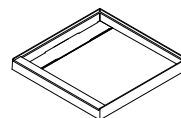

- Add(+)** **C** ACCESSORIES INIT. _____
- ☐ -NCD2 2" No-Caulk Drain Assembly With Removable Strainer
Optional Drain Fitting May Be Used With Either Round Drain Or Trench Drain Styles.



- Add(+)** **D** DRAIN LOCATION - Required Selection INIT. _____
- ☐ -L Left Hand Side (From Entry)
 - ☐ -R Right Hand Side (From Entry)
 - ☐ -C Centered Drain (NOT AVAILABLE WITH TRENCH DRAINS)

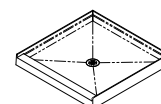
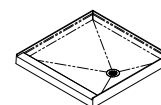
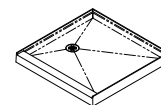

- Add(+)** **E** SHOWER BASE COLOR - Required Selection INIT. _____
- Corterra® Solid Surface Color
- ☐ Blanco Matte -OCC11M (Standard)
 - ☐ Optional Color: _____
(Refer to <https://www.neo-metro.com/corterra-solid-surface> for available colors)
 - ☐ -AMA SteriTouch® Anti-Microbial Additive

SLAB Shower Base

SLAB Shower Base

Shower Base combine attractive looks with a spacious, easy to maintain shower receptacle that features a non-slip, matte finish. SLAB Shower Base sizes and configurations provide flexibility to best suit the building requirements. Units are designed for versatility, durability and ease of installation. Custom sizes and colors are also available (contact Factory Representative).

Construction is Corterra® cast solid surface and is Greenguard Gold listed, cUPC certified by IAPMO R&T and complies to ASTM F 462-79 (R-2007), "Standard Consumer Safety Specification for Slip-Resistant Bathing Facilities."

The 3" wide Integral Threshold provides ample water barrier and allows for installation of a Shower Door (provided by others). The three (non-threshold) sides are provided with Integral Tiling Flanges. Base includes coved interior corners and is pitched to the Drain Outlet to ensure positive drainage.

ADA Compliant Shower Bases are offered for both Transfer and Roll-in Type shower stalls. ADA bases are provided with a lowered Threshold height and must be recessed into the finished floor to facilitate ADA compliance.

Standard Drain opening for 2" No-Caulk Drain. Optional Trench Drain styles include a removable stainless steel Trench Style Cover. All units are cast to accept a standard 2" No-caulk Drain Connection either provided By Others** or optionally available as -NCD2. Optional Drain fitting may be used with either standard Drain or Trench Drain styles. Custom Trench Style Drain Cover is available upon request (contact Factory Representative).

** Drain Connection Models By Others:

- Sioux Chief Mtg. Model 825-2P-PVC
- Oatey Item Number 42045-PVC
- Oatey Item Number 42150-Brass
- Kohler Model K9132-Stainless Steel

GUIDE SPECIFICATION

Provide and install SLAB Solid Surface Shower Base (Specify Model Number and Options). Shower Base shall be made of Corterra® Cast Solid Surface and be Greenguard Gold listed, cUPC certified and comply with ASTM F 462-79 (R-2007), "Standard Consumer Safety Specification for Slip-Resistant Bathing Facilities." The three (non-threshold) sides are to be provided with Integral Tiling Flanges. Base shall have coved corners and non-slip, matte finish floor, pitched to the Drain Outlet for positive drainage. No air holes or pits shall be allowed on the finished surface. Shower Floor is designed to accept a 2" No-Caulk Drain; accessory number -NCD2.



Model Shown: CSB3636ADA-TDS-R-NCD2
36" x 36" ADA Shower Base with Right Hand Trench Drain

SLAB Shower Base

Shower Base Dimensional Information

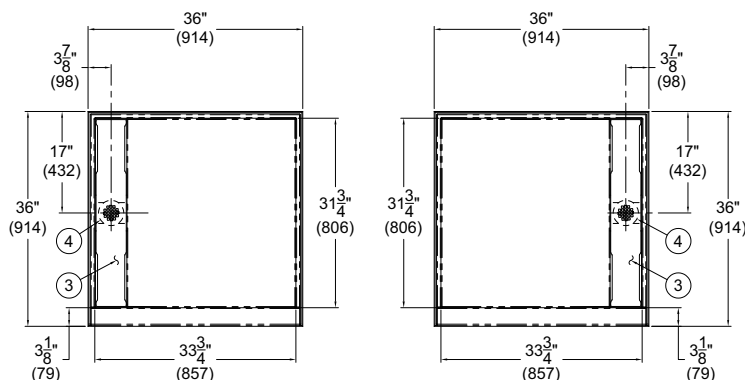

CSB3636-TD-L

CSB3636-TD-R

NOTES:

1. THRESHOLD
2. INTEGRAL TILING FLANGE
3. GRATE COVER
4. OPTIONAL - NCD2 - 2" NO-CAULK WASTE CONNECTION, SHOWN

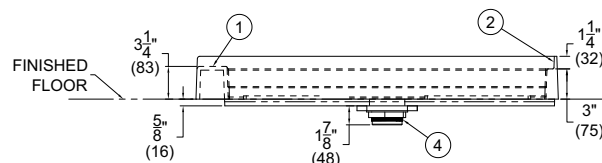

**SIDE VIEW OF TRENCH BASE
DETAIL NOT TO SCALE**

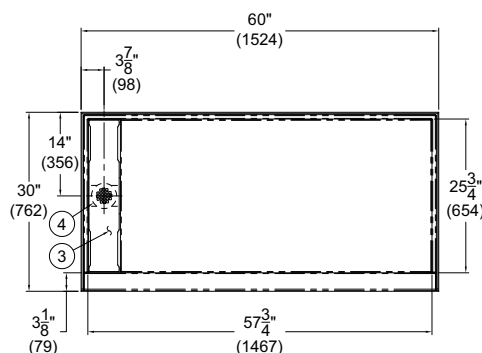

**CSB6030-TD-L
(CSB6030-TD-R OPPOSITE)**

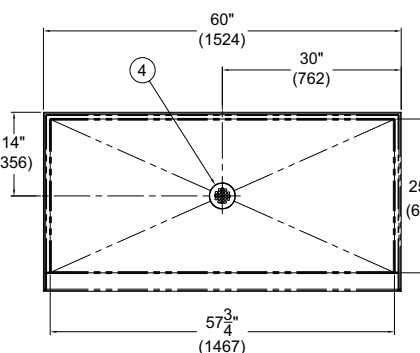

CSB6030-C

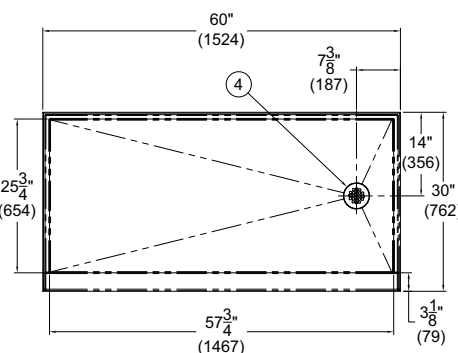

**CSB6030-R
(CSB6030-L OPPOSITE)**

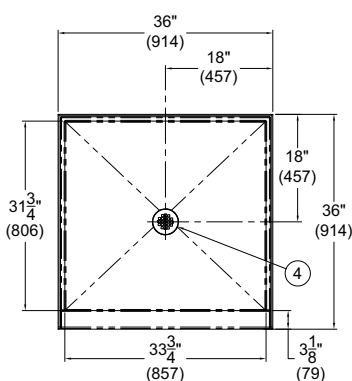

CSB3636-C

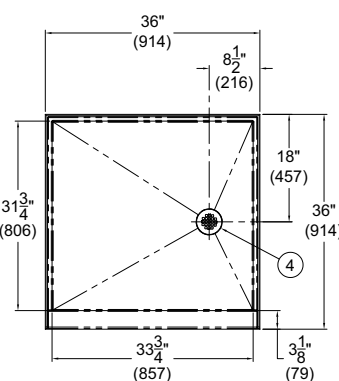

**CSB3636-R
(CSB3636-L OPPOSITE)**

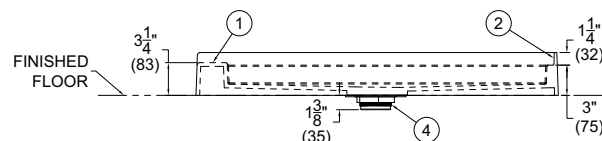

**SIDE VIEW OF STANDARD BASE
DETAIL NOT TO SCALE**

All dimensions are subject to manufacturer's tolerance of plus or minus 1/2" nominal and subject to change without notice. Neo-Metro assumes no responsibility for use of void or superseded data. Neo-Metro, City of Industry, CA, Member of Morris Group International. Please visit www.neo-metro.com for most current specifications.

INSTALLATION INSTRUCTIONS ARE AVAILABLE

Latest product information www.neo-metro.com

Tech Sheet: **TS - SLAB** Page 3/4 Revised: 12/1/2022

NEO-METRO® by ACORN®

A Member of Morris Group International

15125 Proctor Avenue • City of Industry, CA 91746 USA
TF 800.488.8999 • PH 626.366.4561 • FX 626.961.2200

SLAB Shower Base

ADA Shower Base Dimensional Information

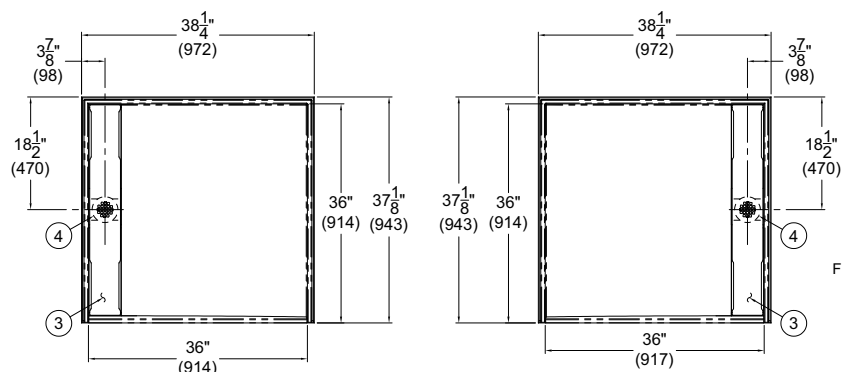

CSB3636ADA-TD-L

CSB3636ADA-TD-R

NOTES:

1. THRESHOLD
2. INTEGRAL TILING FLANGE
3. GRATE COVER
4. OPTIONAL -NCD2 - 2" NO-CAULK WASTE CONNECTION, SHOWN

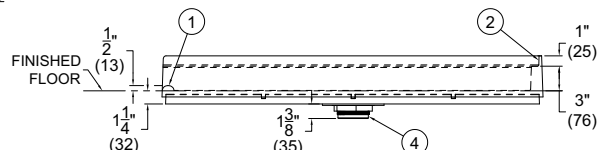

**SIDE VIEW OF ADA TRENCH BASE
DETAIL NOT TO SCALE**

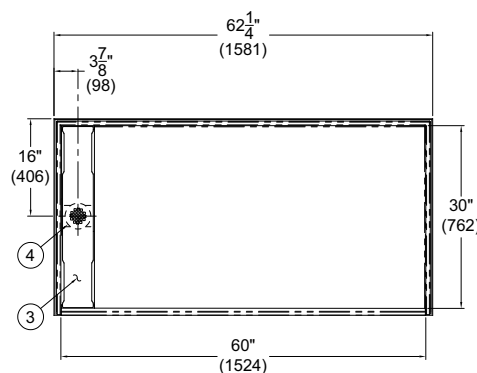

**CSB6030ADA-TD-L
CSB6030ADA-TD-R OPPOSITE**

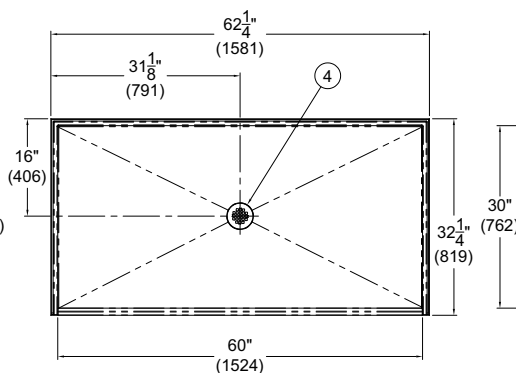

CSB6030ADA-C

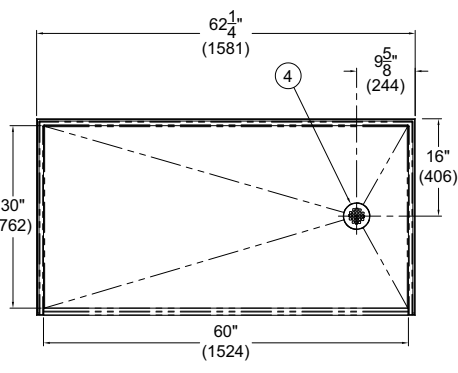

**CSB6030ADA-R
(CSB6030ADA-L OPPOSITE)**

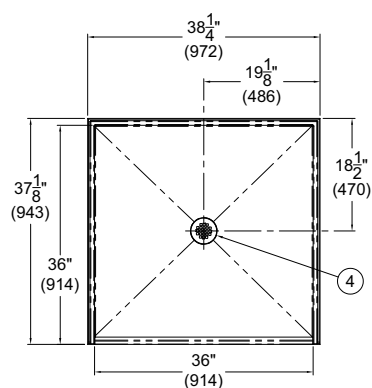

CSB3636ADA-C

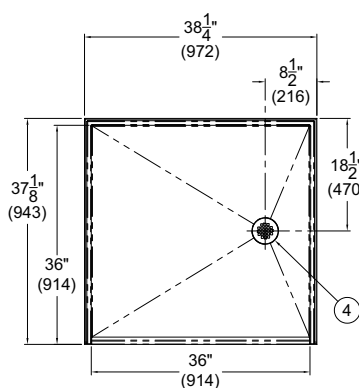

**CSB3636ADA-R
CSB3636ADA-L OPPOSITE**

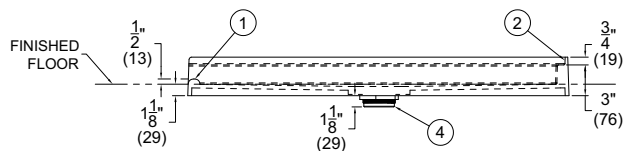

**SIDE VIEW OF ADA BASE
DETAIL NOT TO SCALE**

All dimensions are subject to manufacturer's tolerance of plus or minus 1/2" nominal and subject to change without notice. Neo-Metro assumes no responsibility for use of void or superseded data. Neo-Metro, City of Industry, CA, Member of Morris Group International. Please visit www.neo-metro.com for most current specifications.

INSTALLATION INSTRUCTIONS ARE AVAILABLE

NEO-METRO® by ACORN®

A Member of Morris Group International

15125 Proctor Avenue • City of Industry, CA 91746 USA
TF 800.488.8999 • PH 626.366.4561 • FX 626.961.2200