



Specimen Pass Thru-Door



Technical Dimensions

- ① Cabinet
- ② Wall Frame
- ③ Door
- ④ Mounting Slots
- ⑤ Ø1/4" for Mounting Hardware by others

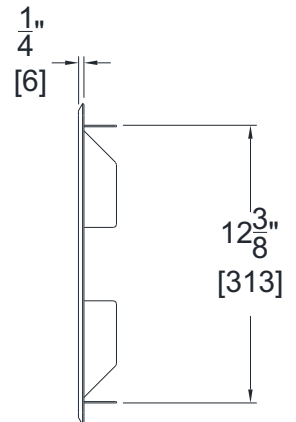
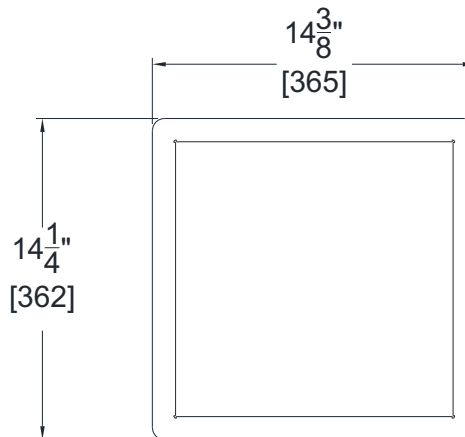
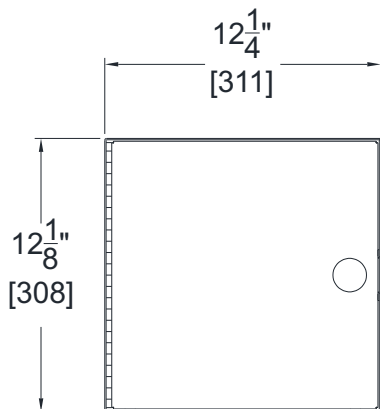
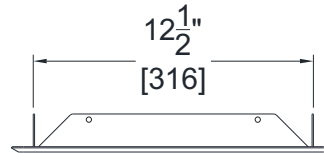
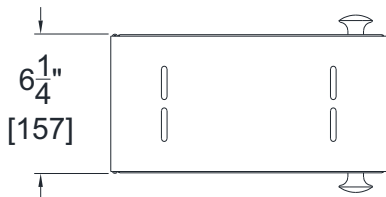
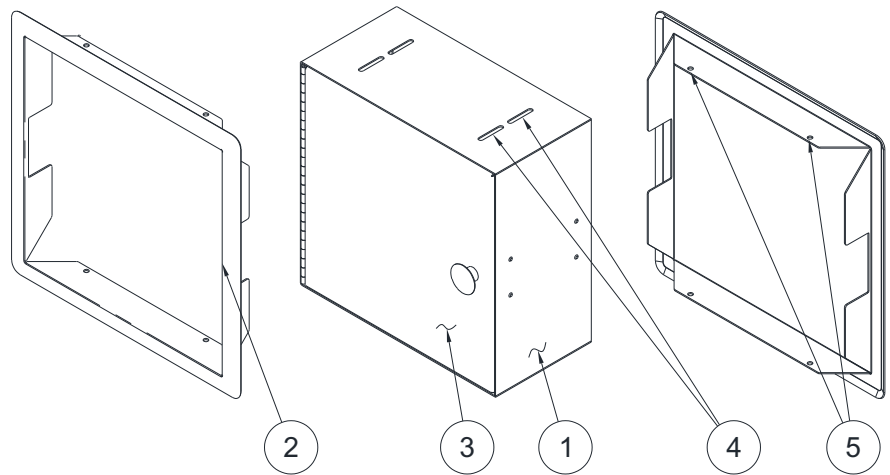

Cabinet

Wall Frame



ROUGH-IN & INSTALLATION INSTRUCTIONS

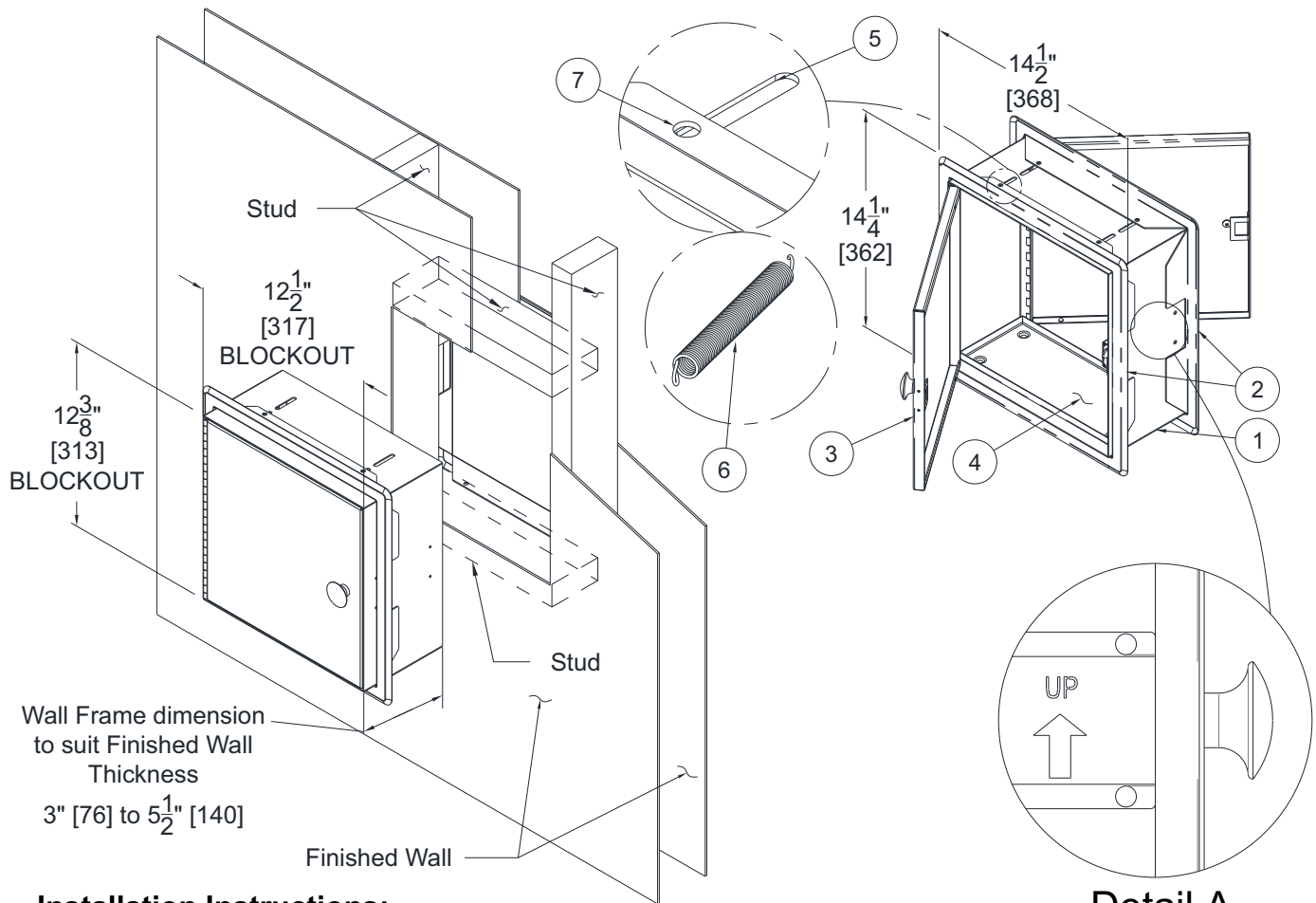

Detail A

Installation Instructions:

- A. Prepare Wall opening using BLOCKOUT dimensions shown. Locate according to Architectural specifications.
- B. Remove Drip Tray [4].
- C. Separate the Wall Frame [2] from the Cabinet [1].
- D. Slide the Cabinet [1] in the up orientation into the Wall Opening. Refer to Detail A.
- E. Position one of the Wall Frames [2] and the Cabinet [1] to a suitable location within the Wall Cavity. From opposite open end install suitable Mounting Hardware (By Others) [7] into the Mounting Slots [5].
- F. If Wall Anchors are being used, mark the locations of the Anchor points, remove Cabinet [1] and Wall Frame [2] and install Wall Anchors.
- G. Repeat installation of opposite Wall Frame [2].
- H. Caulk around Wall Frame [2] as required to suit site conditions.
- I. Return Drip Tray [4].

- ① Cabinet
- ② Wall Frame
- ③ Door
- ④ Drip Tray
- ⑤ Mounting Slots
- ⑥ Door Spring
- ⑦ Ø1/4" for Mounting Hardware by others



Note:

- Disassemble Door Spring if necessary for ease of installation.