

### VARI SLAB™

Solid Surface Countertop  
& Integral Sink



9220-1 WITH OVAL BOWL



9220-2 WITH 3679 (RECTANGULAR) BOWL



9220-3 WITH OVAL BOWL



9220-4 WITH EDGE BASIN

### IMPORTANT

These units are custom to suit specified requirements. Certain details shown in this manual may not apply. Some options may slightly alter installation. To ensure proper installation review the manual thoroughly and verify rough-ins before beginning any work. File this manual with the owner or maintenance personnel upon completion of installation.

Industry standard wall backing, for wall hung fixtures, is required. Installer provided wall anchors and wall anchoring hardware must be appropriate for wall construction.

ANSI or ADA compliance is subject to the interpretation and requirements of the local code authority and is the responsibility of the installer for verification.

Prior to installation, supply lines must be flushed of all foreign material such as pipe dope, chips, or solder. Debris or foreign material in water supply may damage valve.

Teflon tape is recommended on all threaded waste and supply connections to reduce the possibility of leaks.

NOTE: When applicable, receptacle(s) must be wired to a GFCI protected circuit. Fixture must be earth grounded per N.E.C. (National Electrical Code).

## TECHNICAL ASSISTANCE TOLL FREE TELEPHONE NUMBER:

### 1.800.591.9360

Technical Assistance E-mail: [Fieldservice@acorneng.com](mailto:Fieldservice@acorneng.com)

**Note: Refer to individual product installation details for Accessory items not included in this Manual (Faucets, Ect).**

Please refer to the Link or QR code provided For Cleaning & Care Guide:  
[https://www.neo-metro.com/uploads/fileLibrary/cleaning\\_guide.pdf](https://www.neo-metro.com/uploads/fileLibrary/cleaning_guide.pdf)

**NEO-METRO® by ACORN®**  
Acorn Engineering Company  
15125 Proctor Ave. • City of Industry, CA 91746 USA  
TF 800.488.8999 • PH 626.336.4561 • FX 626.961.2200



NEO-METRO® 

**NEO-METRO FIELD SERVICE**  
**TOLL FREE 800-743-8259 • LOCAL 626-855-4866**

## **DIMENSIONAL INFORMATION**

### **-FMTE FRONT MOUNT P-TRAP COVER w/ HINGED P-TRAP ENCLOSURE DIMENSIONAL DATA**

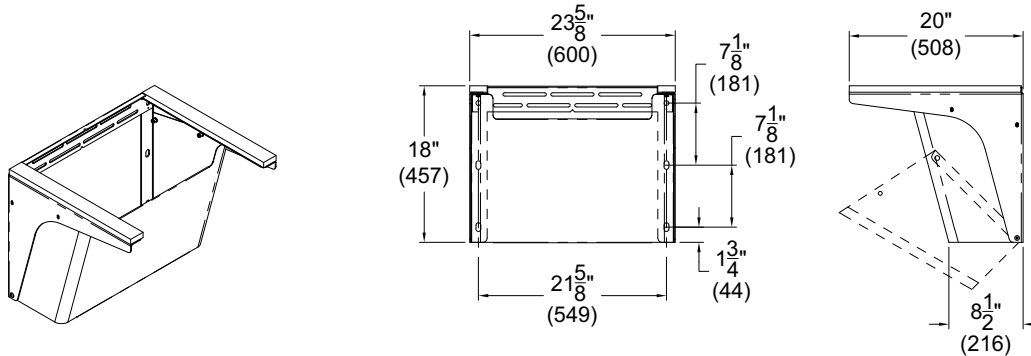

**NOTE: Refer to installation detail found on page 7 for complete information.**

### **-FM FRONT MOUNT BRACKET DIMENSIONAL DATA**

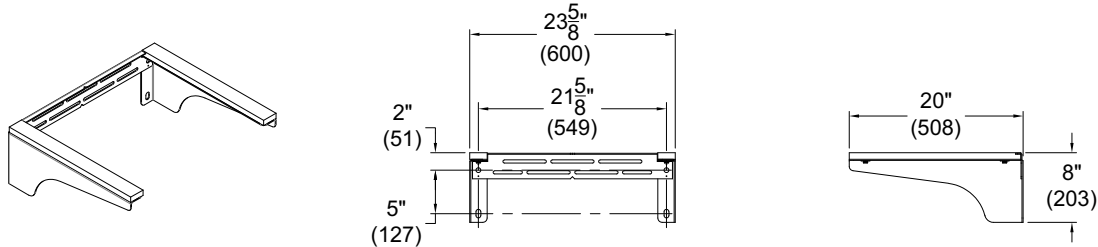

**NOTE: Refer to installation detail found on page 7 for complete information.**

### **-PTC WALL MOUNTED P-TRAP COVER DIMENSIONAL DATA**

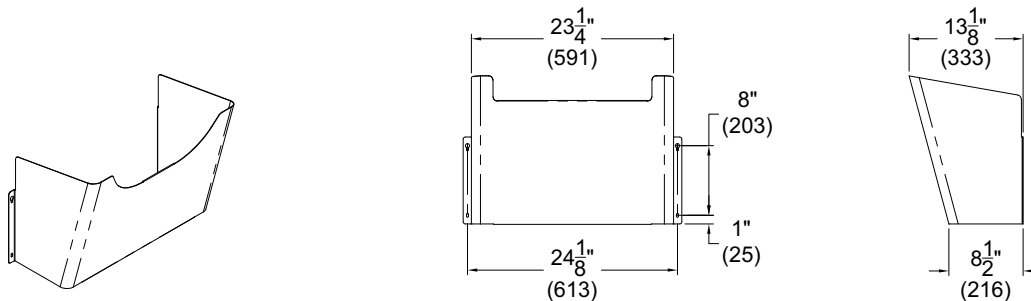

**NOTE: Refer to installation detail found on page 11 for complete information.**

### **SUPPORT ARMS DIMENSIONAL DATA**

**NOTE: NUMBER OF ADDITIONAL SUPPORT ARMS WILL BE DETERMINED BY THE FACTORY BASED ON THE WIDTH OF CUSTOM DECK**

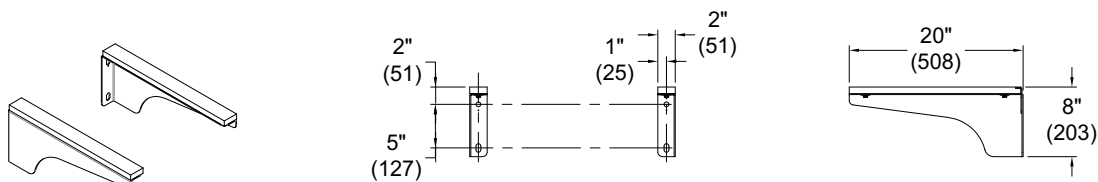

## DIMENSIONAL INFORMATION

**9220 SHOWN  
SIDE VIEW**

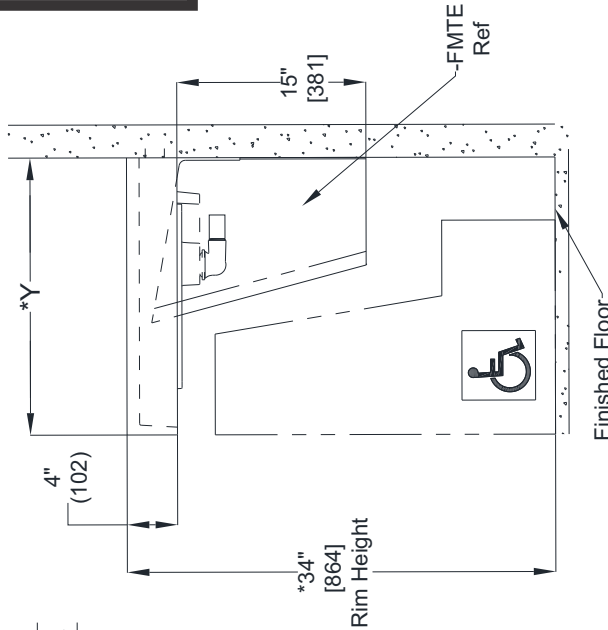

**9220-1 SHOWN  
TOP VIEW**

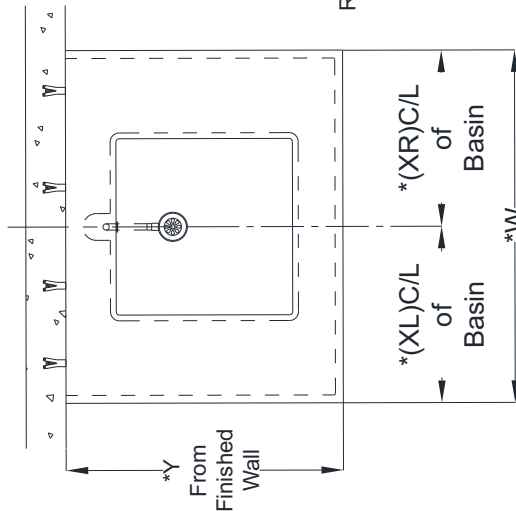

**9220-4 SHOWN  
TOP VIEW**

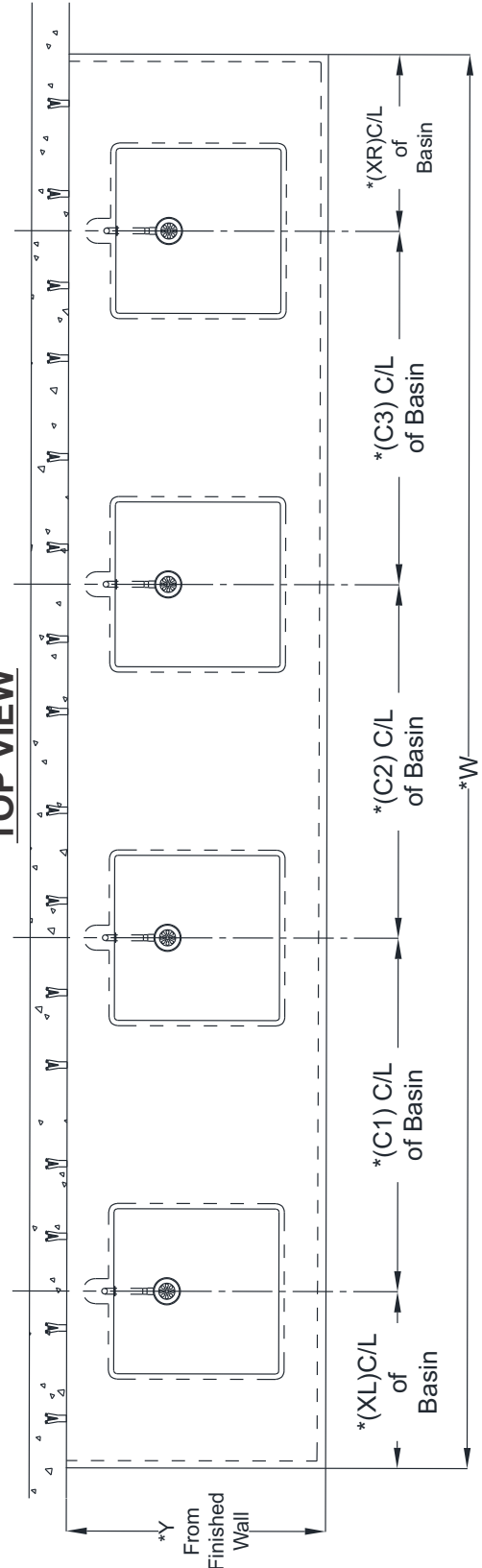

**DIMENSION LEGEND:**

KEY	DESCRIPTION
Y	DEPTH OF DECK
W	WIDTH OF DECK
XL	CENTER OF FIRST BOWL FROM LEFT SIDE OF DECK
C1	CENTER OF FIRST BOWL TO SECOND BOWL
C2	CENTER OF SECOND BOWL TO THIRD BOWL
C3	CENTER OF THIRD BOWL TO FOURTH BOWL
XR	CENTER OF LAST BOWL FROM RIGHT SIDE OF DECK

## ROUGH-INS

### -FMTE / -PT ROUGH-INS

9220-2-BBOC-FMTE SHOWN

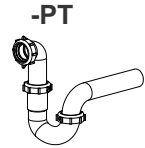
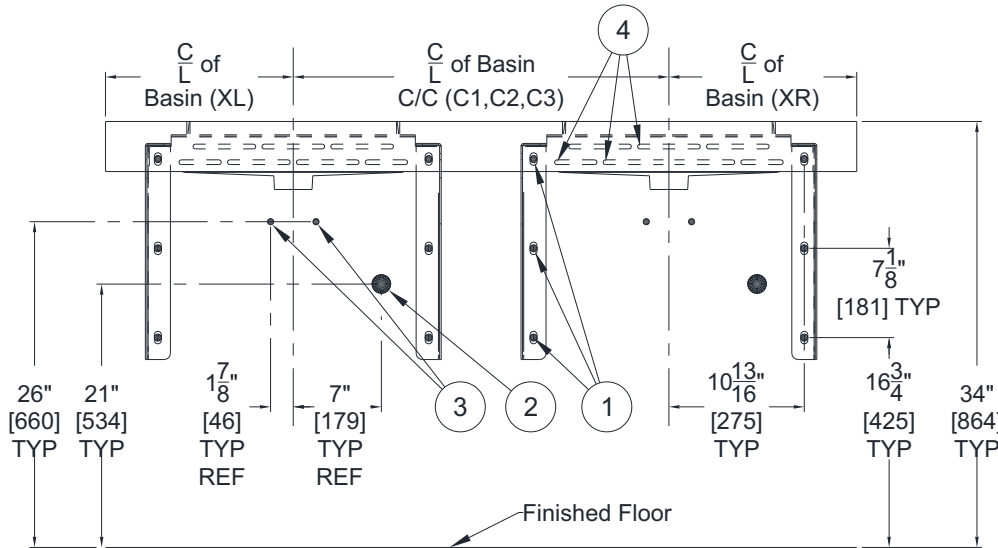

-FMTE

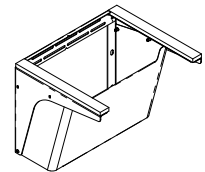

NOTE: dimensions indicated with (\*\*) for optional -PTC P-trap Cover placement is for references and shall be determined by installer. Rough-Ins for Waste Outlet, H & C NPS supplies are for reference and shall be determined by installer to fit site conditions.

### -FM-PTC / -PT ROUGH-INS

9220-2-BBOC-FM-PTC SHOWN

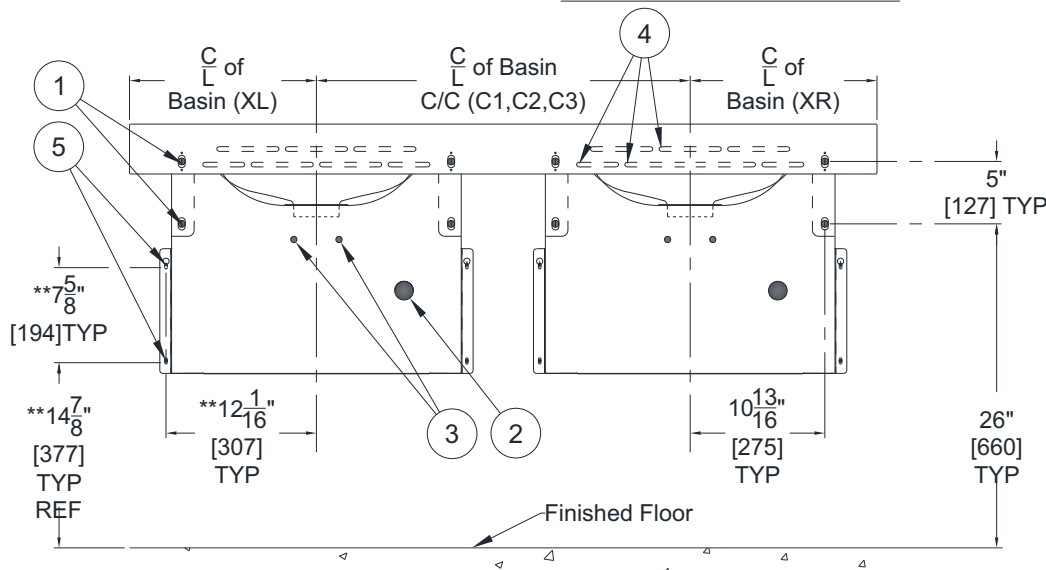

-FM

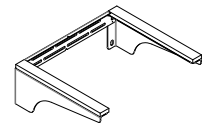

-PTC

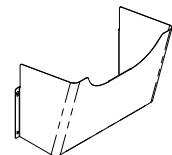

Models shown are for reference only. Units are provided to match selections and dimensions provided by customer. mounting points and plumbing rough-ins are taken from centerlines of basins.

- [1] 9/16" diameter mounting holes for mounting frame, provided. Fasteners and Wall Anchors are provided by others. Installer is to use Industry Standards of Best Practice to suit wall type and construction, weight of fixture and application.
- [2] 1-1/2" O.D. Tube Lavy Waste Outlet for Compression Joint.
- [3] 1/2" NPS Hot & Cold Supplies for angle stop (by Others).
- [4] 3/8" X (3", 4-5/8", 10-1/8") Mounting Slots, Fasteners and Wall Anchors are provided by others. Installer is to use Industry Standards of Best Practice to suit wall type and construction, weight of fixture and application.
- [5] \*\*1/4" X 5/16" Mounting Slots for Optional -PTC P-trap Cover. **NOTE: Mount optional -PTC P-Trap Cover after the Water Supply and Waste Connection(s) are made.**

**GENERAL NOTE:** All dimensions are in Inches [MM].

## -MC / -MCFLR / -MCS MOUNTING ARM CARRIERS

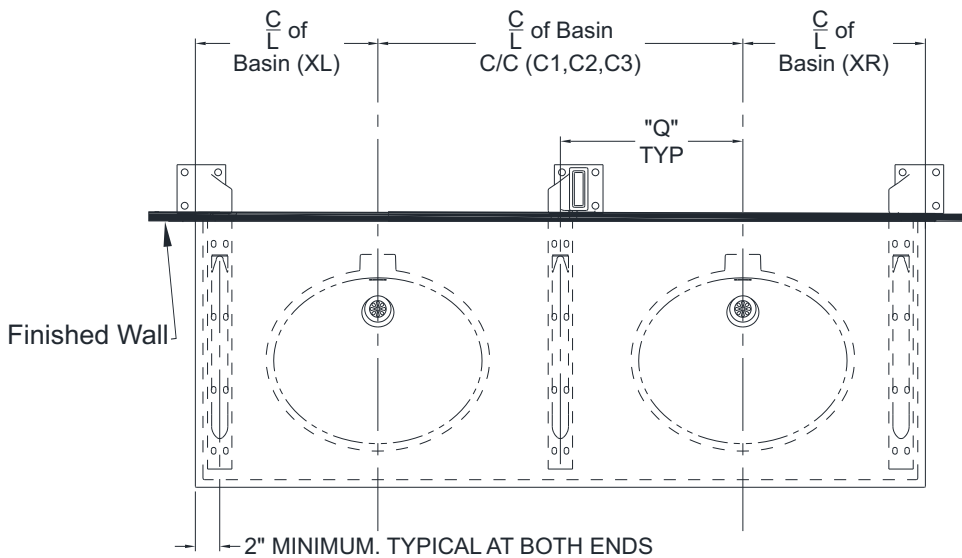

### MINIMUM DISTANCE FROM CENTER LINE -"Q"

EDGE BASIN -BBED	19"
OVAL BASIN -BBOV	19-1/8"
ROUND BASIN -BBRD	16-1/2"
SQUARE BASIN -BBSQ	15-1/4"
RECTANGULAR BASIN -3679	19

Warning: Carrier arms locations may interfere with additional options. Installer should verify prior to installation.

Rough-Ins for Waste outlet, H & C NPS supplies are for reference and shall be determined by installer to fit site conditions.

### -PT Option

- [1] 1-1/2" O.D. Tube Lavy Waste Outlet for Compression Joint
- [2] 1/2" NPS Hot & Cold Supplies for angle stop (By Others)

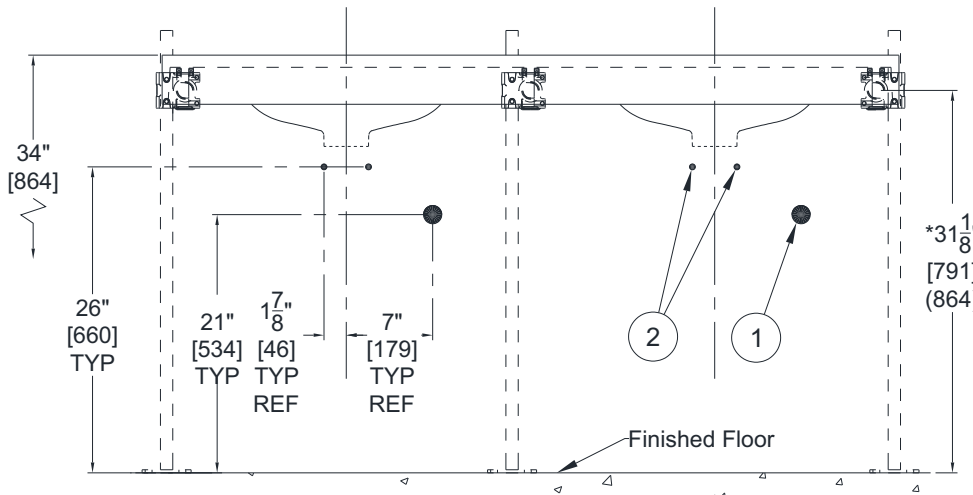

### Standard Arm/Wall Mounted Carrier -MC

Suggested for residential/  
light commercial applications

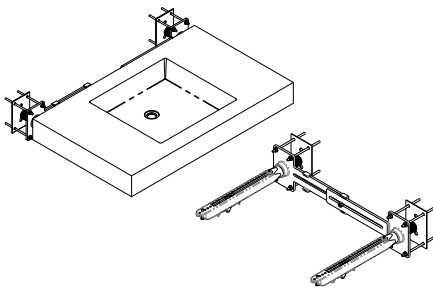

### Mounted Carrier sleeve -MCS

Please refer to table below.

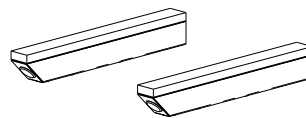

NOTE: RECOMMENDED MOUNTING CARRIER AND SLEEVE QUANTITY IS DEPENDENT ON DECK LENGTH.

Length:	Carrier Sets:	Sleeves:
30" to 45"	1	2
45" to 75"	2	3
75" to 105"	2	4
105" to 135"	3	5
135" to 148"	3	6

### Commercial Floor Mounted Arm/Carrier -MC-FLR

Required for commercial  
application  
(requires 2" x 6" wall construction)

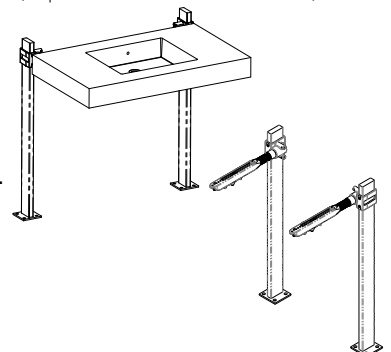

## **-MC / -MC-FLR / -MCS FIXTURE TO CARRIER ASSEMBLY**

Slide lavatory Carrier Sleeves -MCS [14] into Carrier Arms [15]. Level the Carrier Sleeves -MCS [14] using front [16] and back [20] Leveling Screws. To set position of Locking Device [18], turn Set Screw [19] clockwise. Lock lavatory into place by turning Locking Device [18] adjustment stud clockwise. Once Carrier Sleeves -MCS [14] are level, apply a bead of Adhesive [6] (provided by installer) to the Frame Assembly Pads [7]. With Faucet, [8] Grid Strainer, and Close Elbow Assembly [9] installed onto Deck [10], slide Deck [10] into the back wall and set onto Frame Assembly Pads [7], ensuring the back of the Deck [10] is against the back wall and resting on the Frame Assembly Pads [7].

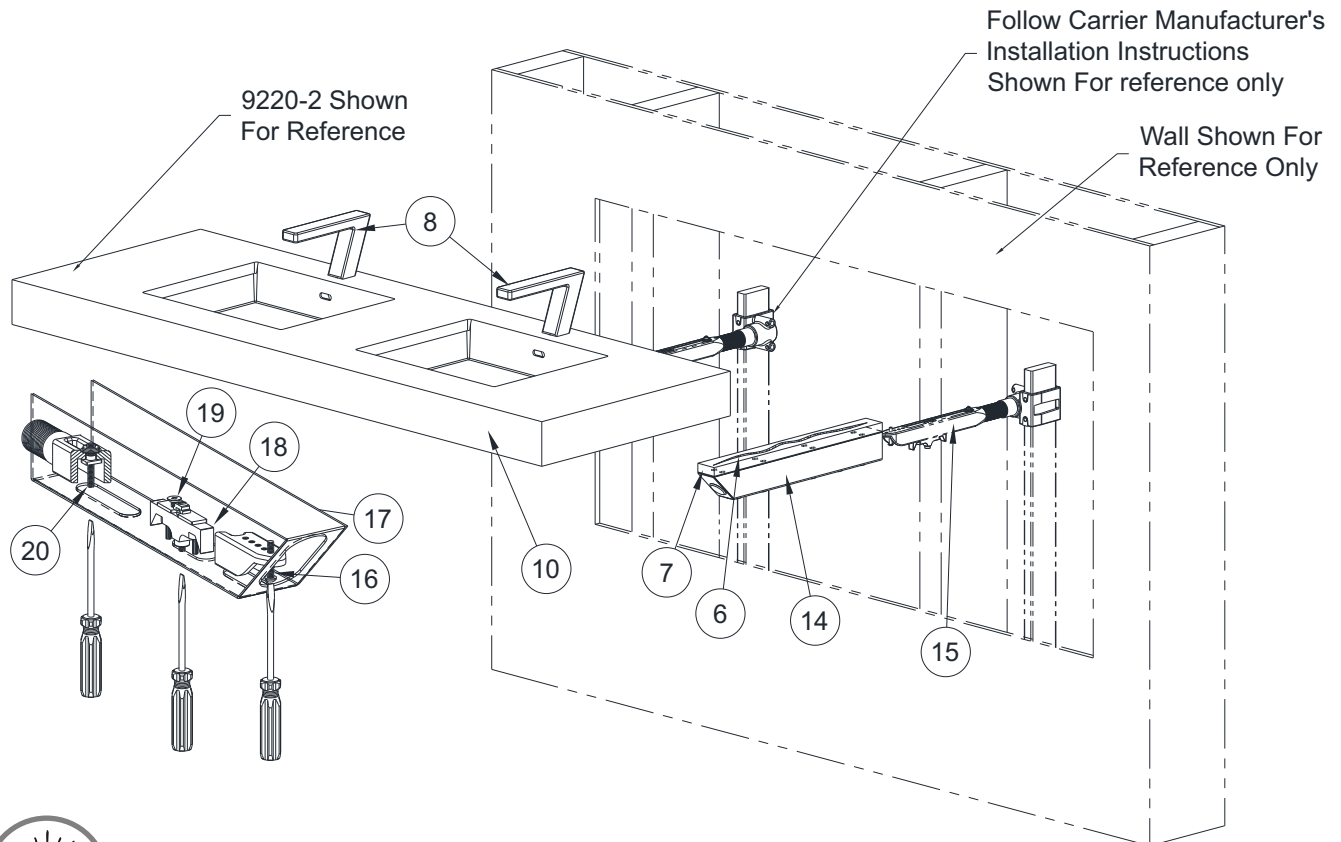

**NOTE:** Prior to installing Carrier arms note the location of additional add ons as they may interfere with the carrier.



### **IMPORTANT**

Applies to units that shall be mounted with a carrier.

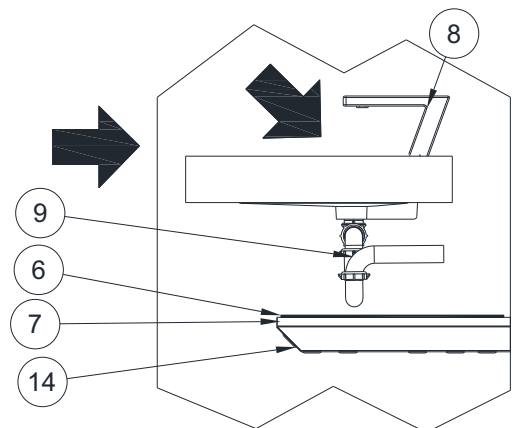

## **- FMTE PRE-INSTALLATION**

Prior to installation remove Hinge P-Trap Cover [1] from the Frame Assembly [2], by removing the Fasteners [3].

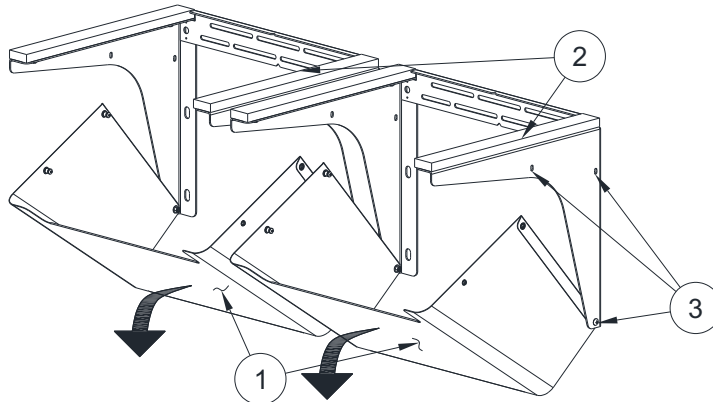

## **-FMTE / -FM INSTALLATION**

With provided wall anchor points [4] installed per rough-ins, slide frame assembly into position and mount to wall using installer provided Mounting Hardware [5]

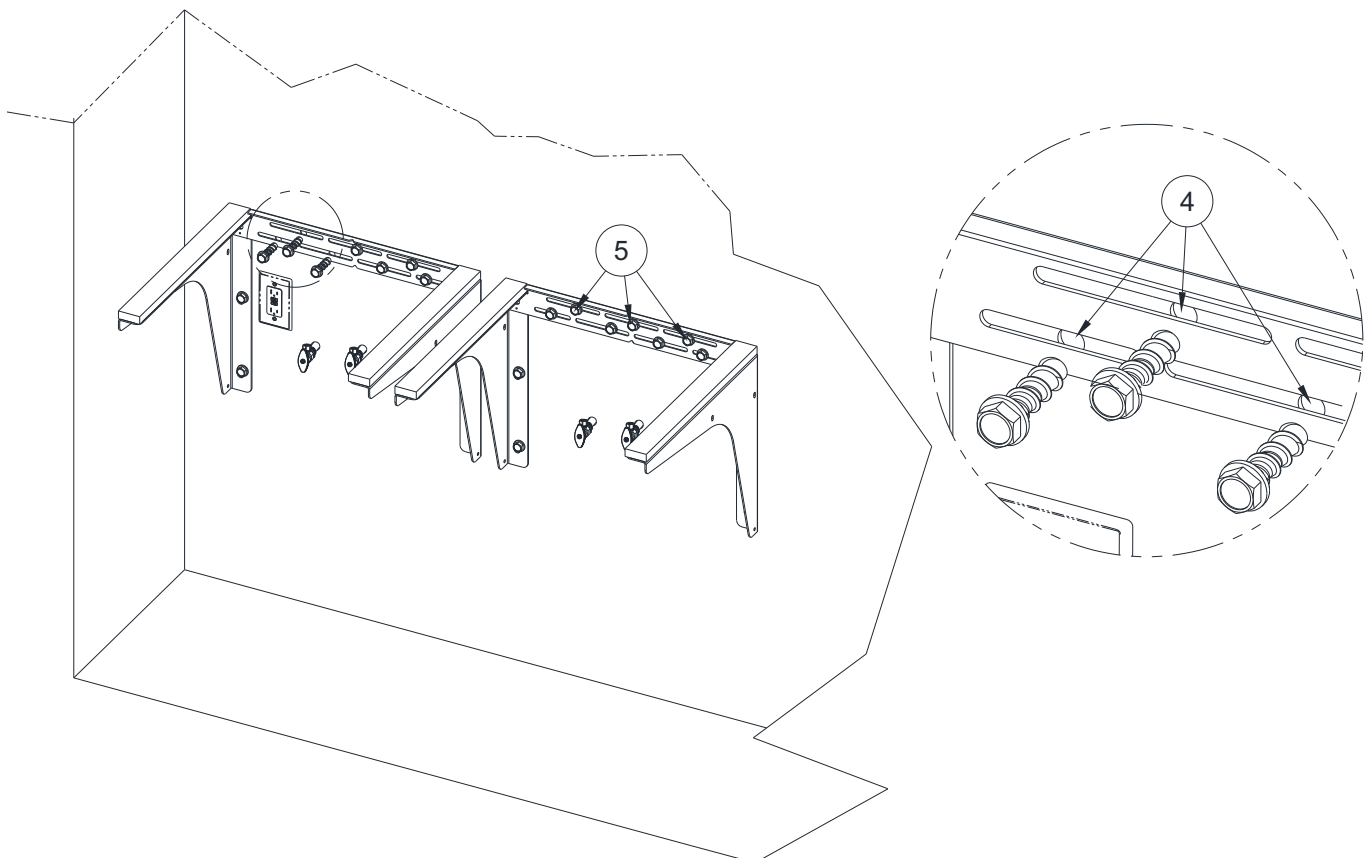



## **-FMTE / -FM TO FIXTURE ASSEMBLY**

With Frame Assembly [2] secured to the wall apply a bead of Adhesive [6] (provided by installer) to the Frame Assembly Pads [7]. With Faucet, [8] Grid Strainer, and Close Elbow Assembly [9] installed onto Deck [10], slide Deck [10] into the alcove or against the back wall and set onto Frame Assembly [2], ensuring the back of the Deck [10] is against the back wall and resting on the Frame Assembly [2] as shown.

**NOTE: Installer is responsible to provide appropriate Adhesive for attaching Deck to Assembly Pads.**

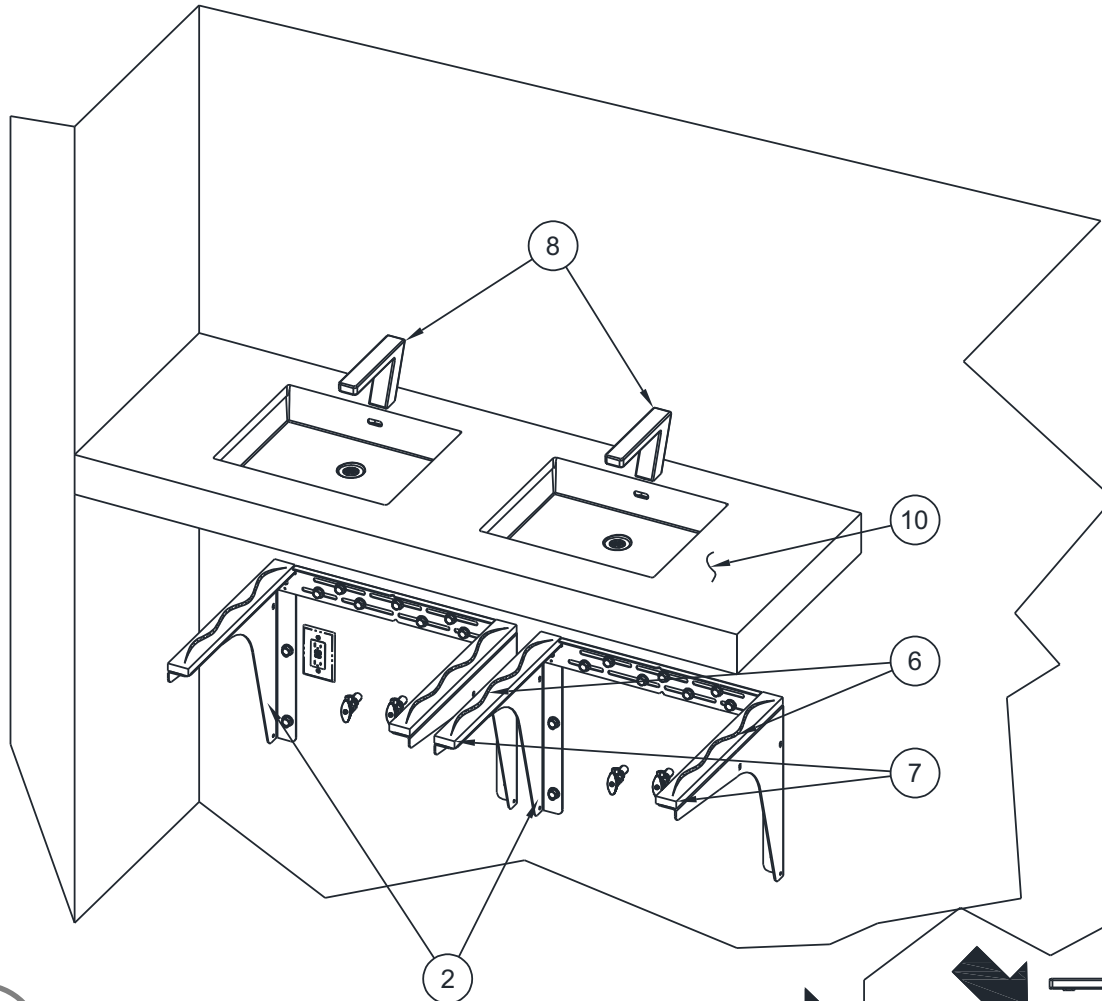

**NOTE:** sides of Deck may need to be field sanded/ground slightly to ensure proper fit within an alcove if applicable.



**NOTE:** if optional back and side splashes are not selected appropriate Silicone, provided by installer, around edges of Deck and Wall.

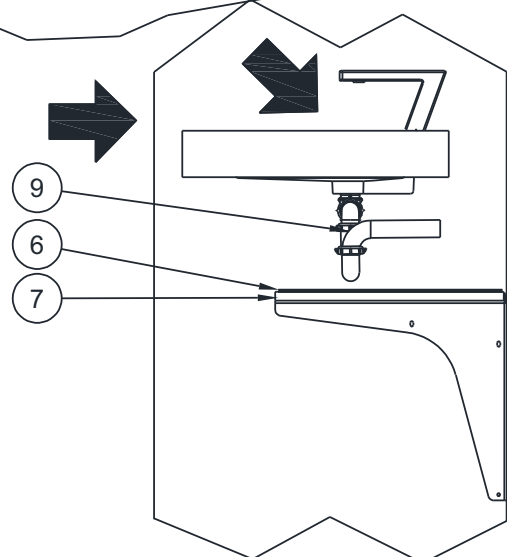



## **-FMTE / -FM / -MC / -MC-FLR TO FIXTURE ASSEMBLY**

With Deck [10] secured to Frame Assembly [2], apply a bead of Adhesive [11] to the walls or the backside of Side-splashes [12] and Back-splashes [13] and set on top of Deck [10] then press and hold against wall until Adhesive sets and they stay in place.

**NOTE: Installer is responsible to provide appropriate Adhesive for attaching Back or Side Splashes to Walls.**

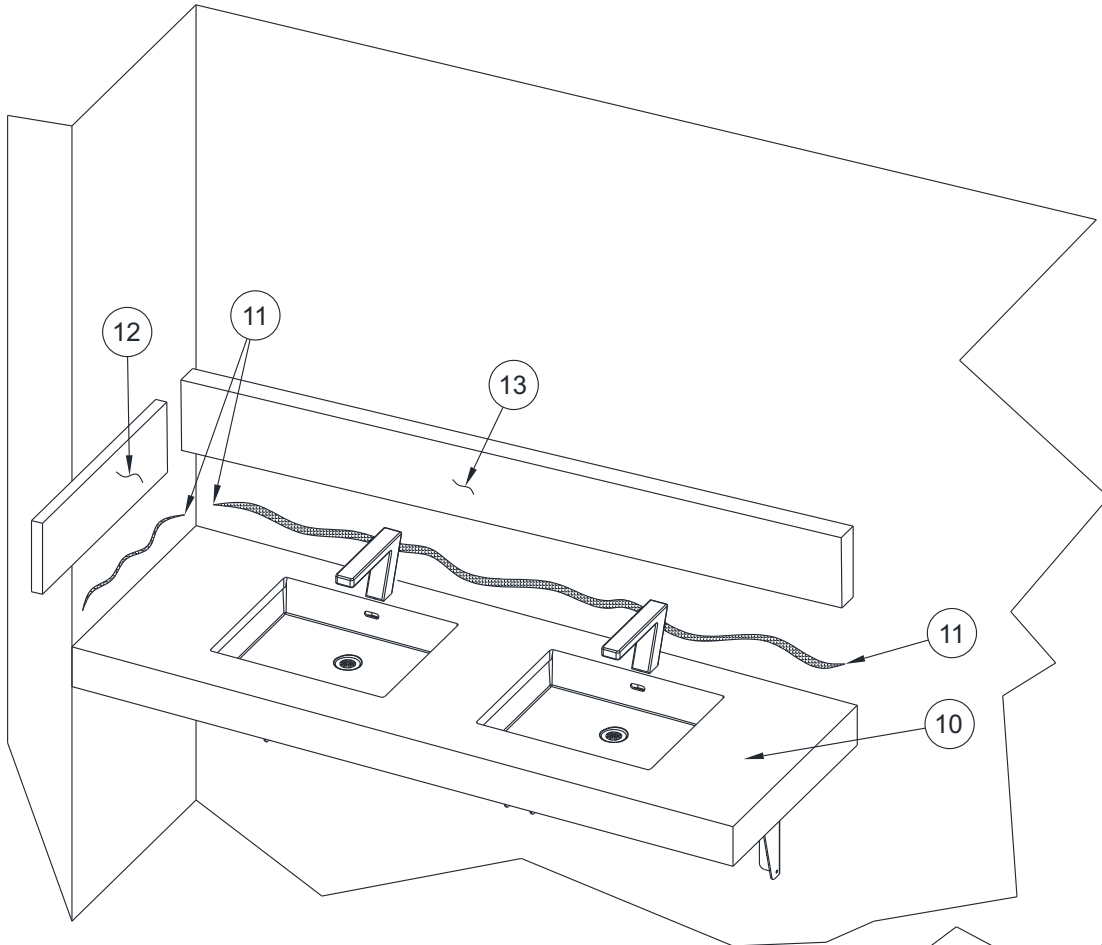

NOTE: sides of Deck may need to be field sanded/ground slightly to ensure proper fit within an alcove if applicable.



NOTE: apply appropriate Silicone, (provided by installer) around edges of Back and Side Splashes, Deck, and Wall.

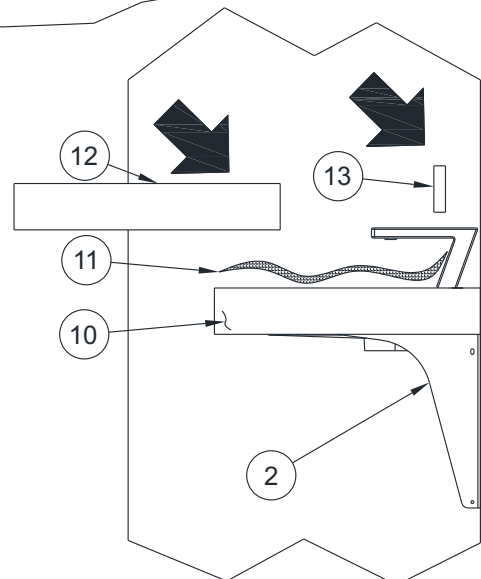

## **FIXTURE ASSEMBLY**

Prior to installing the Deck onto Frame Assembly, it is recommended to install the Optional Grid Strainer & Optional Close Elbow assembly as shown & Optional Faucet.

**NOTE:** Refer to individual product installation Details for Accessory items not included in this Manual (Faucets, Ect).

## **-PT WASTE ASSEMBLY**



**HINT:** Teflon tape is recommended on all threaded waste and supply connections.

Install Strainer to Basin using plumbers putty on underside of Grid Strainer Flange. From beneath Basin, assemble Gasket, Washer and Jam Nut as shown to Strainer and tighten securely. Add Close Elbow to Strainer Assembly as indicated.

- [1] Strainer w/ 1-1/2" -16 UNE Threads
- [2] Rubber Gasket (1) required
- [3] Flat Fiber Washer (1) required
- [4] 1-1/2"-16 Brass Nut
- [5] 1-1/2"-16 x 1-1/4" UNI Close Elbow with 3/8" NPT Clean-Out Plug
- [6] 1-1/4" O.D. Waste Outlet Connection

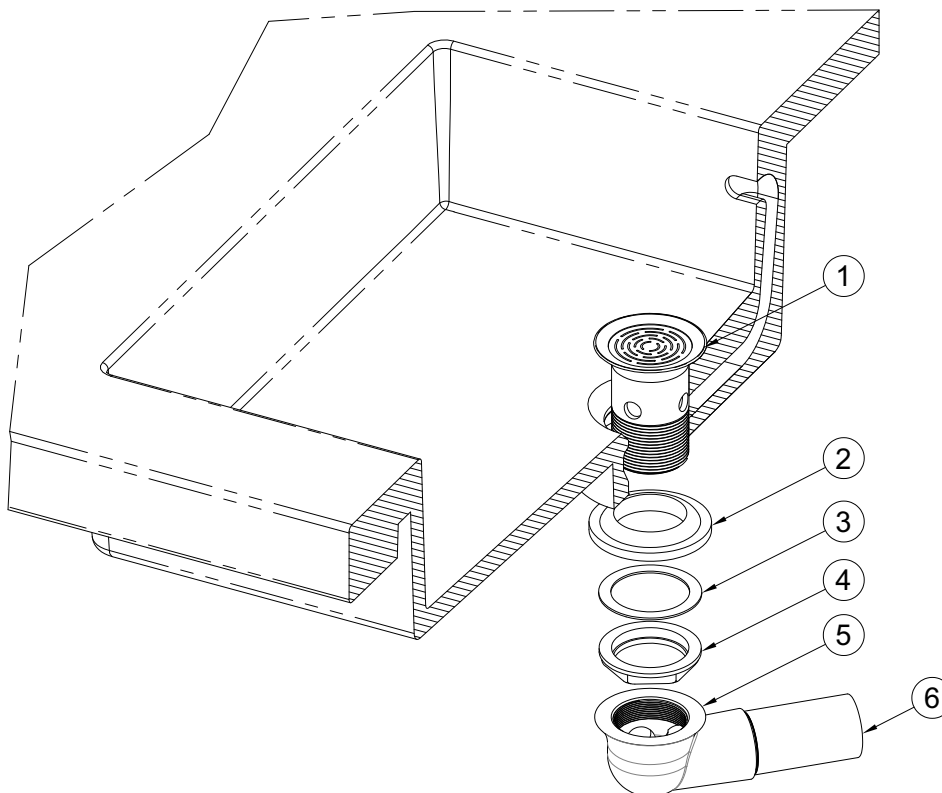

**NOTE:** Waste Assembly may be provided with Extra items not required in this assembly.



**NOTE:** Waste assembly may require field cutting and fitting by the installer.

## **-FMTE TO FIXTURE ASSEMBLY**

Secure Hinge P-Trap Cover [1] to Frame Assembly [2] with Vandal Resistant Fasteners [3].

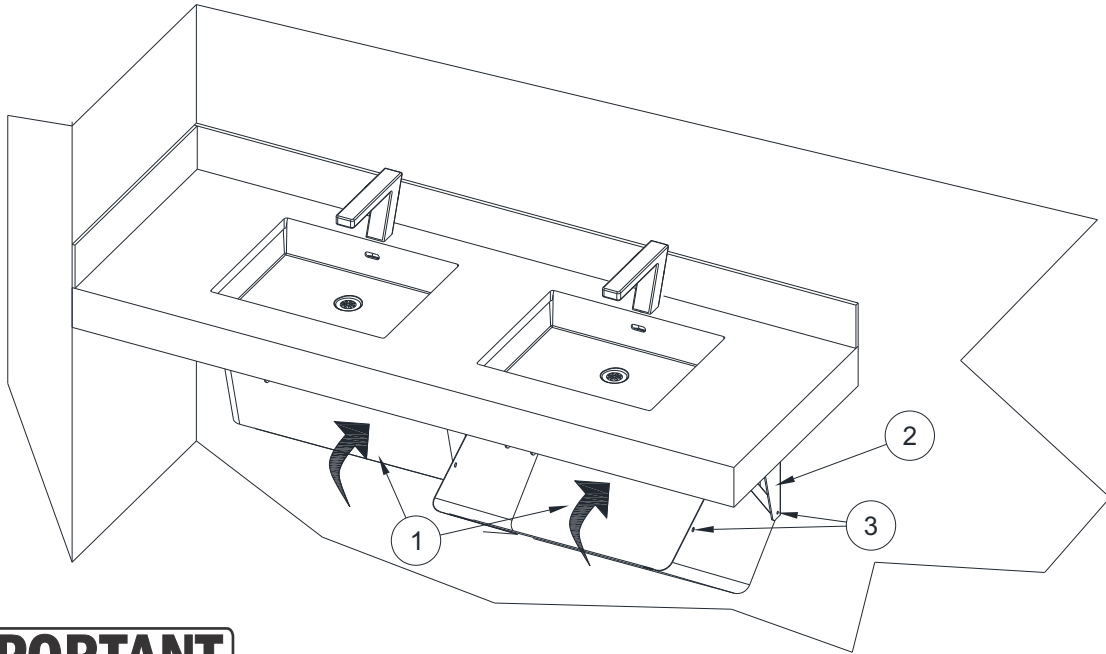

### **! IMPORTANT**

Before Re-installing Hinge P-Trap Cover(s) it is the installers responsibility to open stop(s), run Faucet(s) and inspect for leaks. If leaks are detected they must be corrected.



NOTE: -PTC Wall Mounted trap Cover should be Installed after the unit has been checked to run properly and for leaks.



NOTE: -PTC Wall Mounted trap Cover Dimensions are for reference only and shall be determined by installer.

### **-PTC WALL MOUNTED P-TRAP COVER**

