

SVB Series**Surface Mounted Valve Boxes**

Surface Mounted Valve Boxes provides a fully enclosed access box to valves and controls that may extend outside of the finished wall.

Door are fabricated from 16 gage, stainless steel with a satin finish.

Box is fabricated from 16 gage, type 304 stainless steel with exposed surfaces polished to a satin finish. all seams are continuous welded. It is furnished with four 1/4" x 1/2" slots on the back for mounting. All anchoring hardware by others.

Exposed Piano Hinge is continuous.

Latch is screwdriver operated.

Finish is a satin finish.

Guide Specification

Provide Elmdor® SVB Series, Surface Mounted Valve Box (Specify model number and options). Door and Box shall be fabricated from 16 gage, type 304 stainless steel with exposed surfaces polished to a No.4 finish. The door is provided with full length piano hinge. Box with all seams are continuous welded. Latch shall be screwdriver operated.



Member of U.S. Green
Building Council

SVB

Revised: 08/31/18

Recyclable
Product



MODEL NUMBER AND OPTIONS SELECTION

BASE MODEL NUMBER

☐ SVB Surface Mounted Valve Box

Suffix Options

- ☐ - AKL Allen Key Latch
- ☐ - CL Cylinder Lock
- ☐ - CLD Cylinder Lock with Dust Shutter
- ☐ - PC Prime Coat

STANDARD AVAILABLE SIZES

Special sizes available upon request.

NOMINAL DOOR SIZE (W x H x Depth)	LATCH	WEIGHT
SVB 8" x 8" x 4"	1	10.0 lbs.
SVB 8" x 8" x 6"	1	12.0 lbs.
SVB 8" x 8" x 8"	1	12.0 lbs.
SVB 12" x 12" x 4"	1	18.0 lbs.
SVB 12" x 12" x 6"	1	20.0 lbs.
SVB 12" x 12" x 8"	1	26.0 lbs.

NOTES:

1. EXPOSED PIANO HINGE
2. DOOR
3. BOX
4. SCREWDRIVER LATCH
5. MOUNTING SLOTS

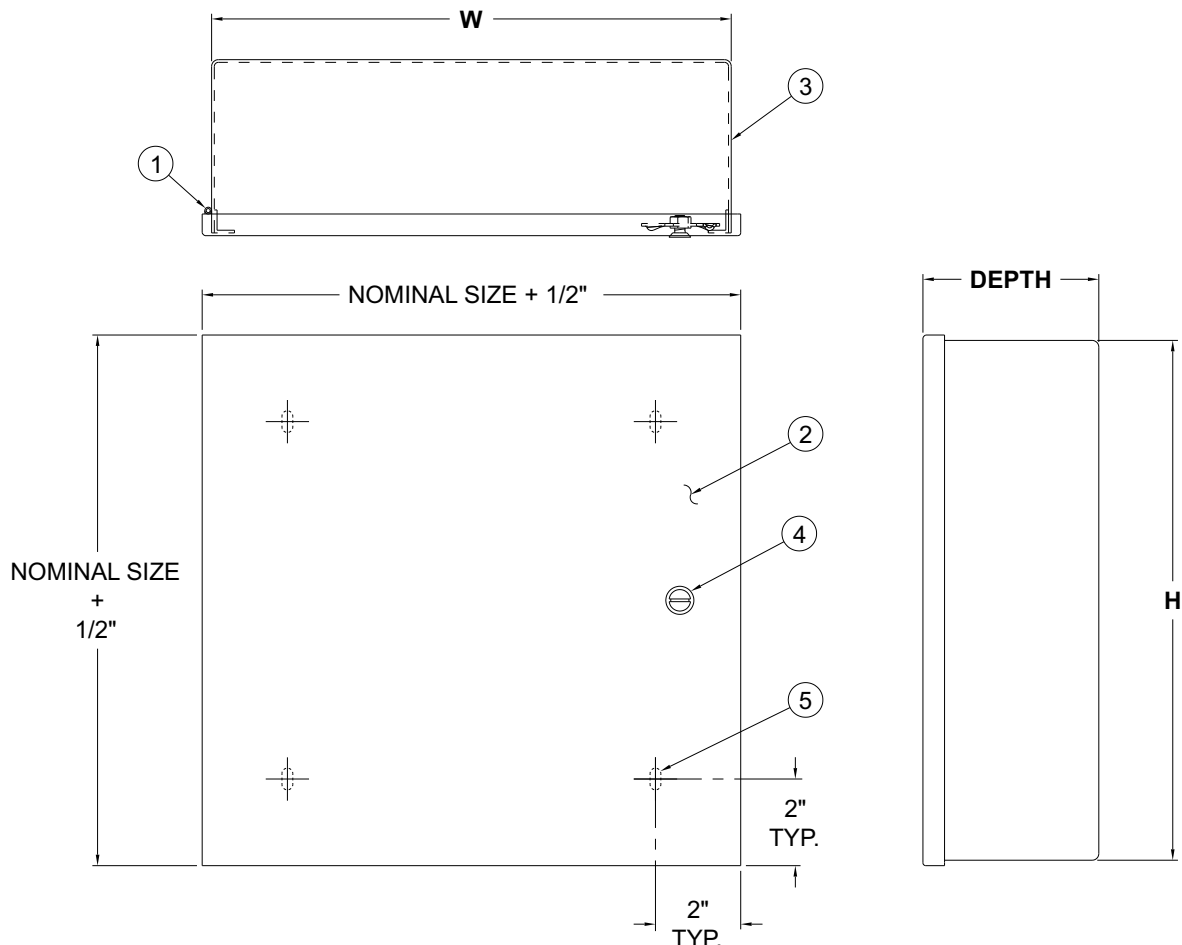

WARNING: Cancer and Reproductive Harm - www.P65Warnings.ca.gov

Dimensions are subject to manufacturer's tolerance of plus or minus 1/4". Elmdor/Stoneman assumes no responsibility for use of void or suspended data. Please visit www.elmdorstoneman.com for most current specifications. © Copyright 2009 Elmdor/Stoneman, City of Industry, CA, A Division of Acorn Engineering Company.

SELECTION SUMMARY & APPROVAL FOR MANUFACTURING

Model Number & Options _____ Quantity _____
Company _____ Date _____
Contact _____ Title _____
Approval for Manufacturing/Signature _____

SVB

Revised: 08/31/18